



Māpua School

"To Be All I Can"

Information Booklet





Contents

Our Vision

Our Beliefs

School Map

Special Features of Our School

ABC of Important Things

Zoning Map

Contact Numbers

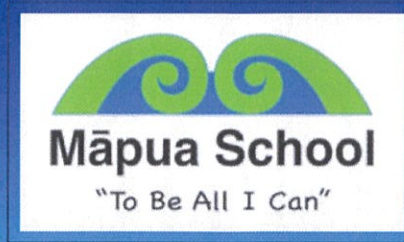

At Māpua School Our Vision Is For Everyone...

... 'To Be All I Can'.

Our Mission is that Māpua School Children will...

- Be responsible community members.***
- Have high academic success.***
- Be competent in communication.***
- Be active.***
- Be creative.***
- Be effective thinkers.***

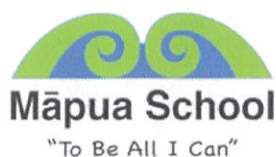

Our Beliefs

To be responsible community members.

This is developed through our virtues where we support Māpua children to ...

1. make positive choices
2. be respectful
3. have an effective relationship between home and school
4. recognise and celebrate success
5. be an active and supportive team member
6. be active guardians of our environment

To have high academic success.

Māpua children will ...

1. achieve personal excellence in Literacy and Numeracy
2. set and achieve realistic goals
3. have access to a variety of tools to be a self learner
4. have high expectations
5. have a high level of self belief to achieve personal success
6. have opportunities to extend themselves

To be competent in communication.

Māpua children will ...

1. be active listeners who question carefully
2. be confident and clear speakers
3. have high levels of Literacy skills (understanding texts, writing features and I.C.T. (Information Communication Technology))
4. use language appropriate to the setting and the purpose
5. be exposed to other languages

To be active.

Māpua children will ...

1. be physically fit
2. have a 'can do' attitude
3. be accepting of others' strengths and weaknesses
4. have EOTC (Education Outside the Classroom) opportunities
5. participate competitively

To be creative.

Māpua children will ...

1. be exposed to a broad range of elements of the Arts
2. be risk takers and problem solvers
3. accept constructive criticism
4. be supportive of peers, teachers and support staff

To be effective thinkers.

Māpua children will ...

1. understand and use thinking tools
2. take risks
3. question and enquire
4. have an opinion

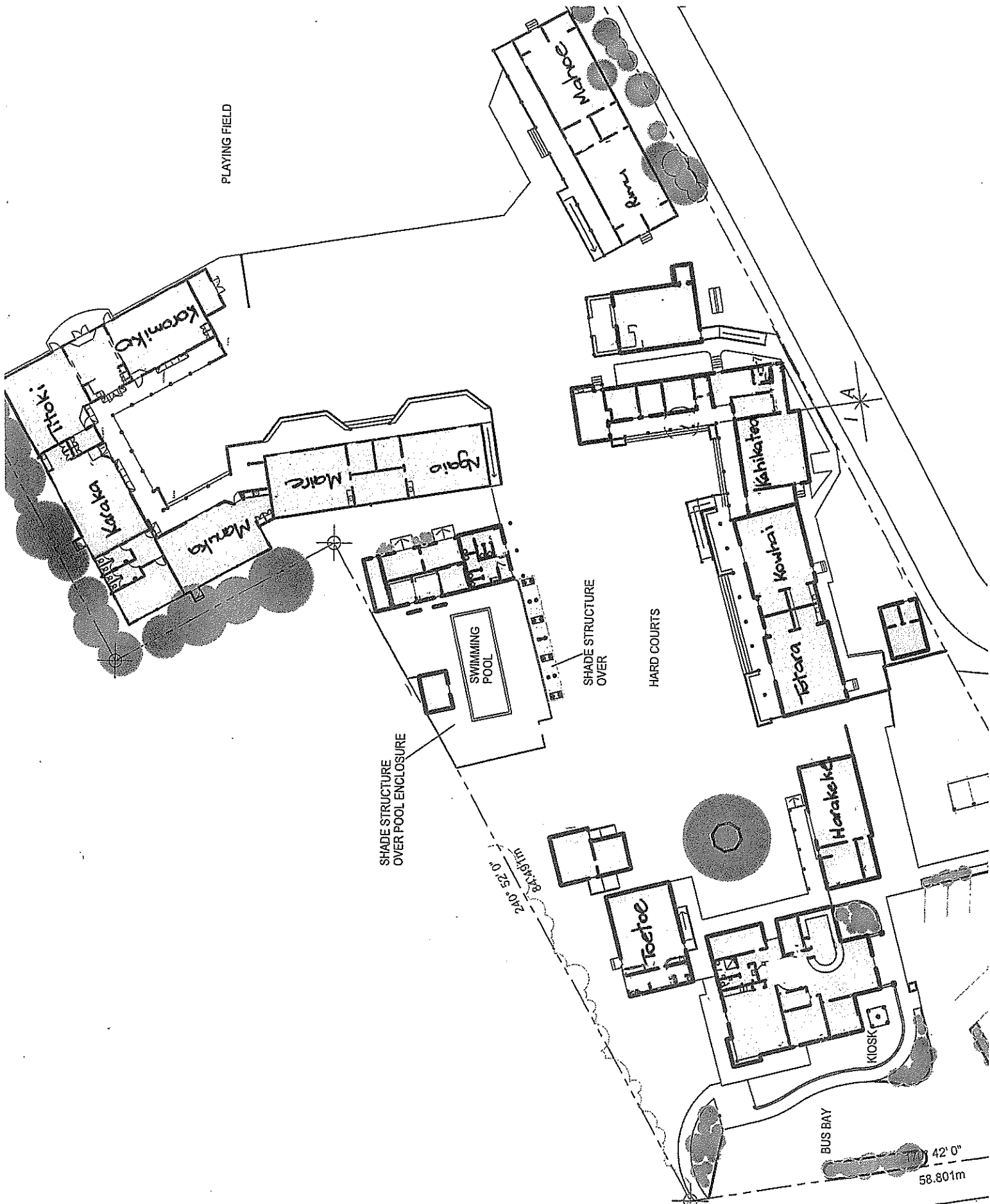

Special Features of Our School

Education Outside the Classroom (EOTC)

A comprehensive programme of EOTC takes advantage of the immediate seaside locality of Māpua, as well as Abel Tasman, Nelson Lakes and Kahurangi National Parks.

Residential camps in Years 5-8 aim to give first hand experiences in learning by exploring the environment, developing social skills, and providing challenging and new experiences. In Years 7-8, camps will alternate between an urban and an outdoor experience.

A two year cycle of camps involve the Year 5-6 classes having a four day and Year 7-8 having 5 day residential camps at various locations.

Years 3-4 have a Big Day Out and alternate between using the local environment and travelling further afield for the day.

All classes use the local environment for a variety of learning experiences including the beach.

These programmes are planned to meet the requirements of the Physical Education and Health Curriculum. Schoolwide Policies and Procedures are used to manage the risks in the outdoors.

School Magazine

The magazine is produced at the end of each year highlighting activities over the whole school. Senior students with a passion for writing are invited to be part of the team of journalists. A competition is held to select the outside and inside cover designs and the name for the magazine.

Sport

Weekly Sport occurs in the Senior and Intermediate teams throughout the year and options include the mainstream sports (Cricket, Softball, Soccer, Hockey, Touch).

Schoolwide events include annual Swimming Sports Athletics, Tryathlon, Cross Country and House Days run by the House Leaders.

Interschool events include Swimming Sports, Athletics, Gymnastic Competitions, Winter Sports tournament and Cross Country.

Out of School Sports Teams may include Touch, Basketball, Football, Cricket and Netball. These activities incur a charge for each student participating which must be paid prior to the activity starting.

Things I'm Great At (TIGA Programme aka Gifted & Talented Education)

Our programmes cater for a wide range of students with many different strengths or passions. We avoid stating any specific percentage of the school population as being gifted or talented, instead we take each child on his or her merits, identifying areas where there is a need to further develop a strength or talent.

First and foremost these students needs are met in the classroom. When planning for students with special abilities the teachers ensure that their learning needs are met through activities that have more depth, complexity and choice.

The next tier to our TIGA programme is opportunities for learning outside the classroom. This includes things such as GATE conferences, Motueka High School workshops (Years 7-8 only), competitions (e.g. Mathix, speech, chess tournament), authentic tasks for the school or community (e.g. Tane's Ark, school magazine, murals for school buildings) and/or working with specialist teachers.

Student initiated learning programmes are another opportunity to cater for all students in learning teams.

Learning Support Programmes

We support all learners and provide opportunities for students with learning needs in a number of ways: Reading Support programme, Reading Recovery, access to Specialist services and the Learning Support Co-ordinator.

Year 7-8 students

High standards of behaviour and work presentation are set at this level. The Year 7-8 students fulfill a number of important roles, eg leaders in Tuakana Teina (where they are buddied up with a younger buddy), House leaders, participation in ANZAC Day services, and magazine journalists. These students have also participated in the William Pike Challenge which is a leadership programme based on community service, outdoor activities and learning a new skill of their choice.

As a member of these classes, students have great access to a wide range of events. These include Literacy Quiz, Technology Challenge, Nelsonmathix, Science Fair and Smokefree Speeches.

Students in the Intermediate Team attend a weekly Technology programme, (MOTEC) at Parklands School, Motueka.

Music Tuition

A guitar tutor is available on a user pays basis for tuition during school time in our music suite.

ABC of important things you need to know

ABSENCES

For safety reasons Parents/Caregivers must notify the school office by 8.45am if students are going to be away and the reason for the absence. The Ministry of Education require schools to record the reason for absences. Every endeavour will be made to contact parents for non-notified absences. You can contact the school via Spotlight (the parent portal), phone 540 2806 (there is a dedicated absence line) or email the office: admin@mapua.school.nz. The administration team will let the teacher know of your child's absence.

ASEMBLY

Whole school assemblies are usually held fortnightly at 2pm. Parents/Caregivers are welcome to attend.

BANK ACCOUNT

The school bank account is 03 1354 0326037 00 (NBS, Motueka)

BOARD OF TRUSTEES

The Board is comprised of five elected Parent Representatives, a Staff Representative and the Principal. They are responsible for all areas of governance. Meetings are open to the public. Minutes and other meeting information can be found at the school office. Members can be contacted through the school.

Bus

Our school bus runs a route which is determined by the School Transport Service. For further details about the bus routes and times etc, please contact the office who can give you contact details for the teacher who is the Bus Controller.

CONCERNS

Communication between home and school is a vital part of your child's education. If you have concerns or questions, please see the classroom teacher. If these remain unresolved, you should talk to the team leader and, finally, the Principal.

CYCLISTS

Cyclists should use the cycleway and wear shoes and a safety helmet. Students under 10 years of age are not permitted to cycle unless accompanied by an adult. Helmets are compulsory.

DENTAL THERAPISTS

Dental therapists visit the school periodically in the mobile clinic. Should dental problems occur when they are not at Māpua, please phone 0800 833 846.

DONATIONS

A parent donation of \$130.00 per child is requested. Included in this is an "activity fee" of \$35. Other requests for payments are on the stationery lists for each team - see separate section on our webpage.

ENROLMENTS

New Entrants

Children enrolling at school for the first time must present proof of age such as Birth Certificate or Passport. We encourage all parents of new entrant children to arrange pre-entry visits. This helps the child to become familiar with the teacher, other children, the surroundings and the routines before beginning school. When enrolling five year olds, an immunisation certificate obtained from your doctor must be presented. This is a directive from the Ministry of Health.

Other Enrolments

We welcome enrolments at all levels and this can be done through the office. We are always willing to show prospective families our school.

FOMS (Friends of Māpua School)

An active FOMS group fulfils a number of important roles such as social events, welcoming families, class liaison and raising funds. They are always looking for new members. Contact the school office for details of FOMS members.

HOME LEARNING

Parents will be notified of their child/ren's home learning expectations at the beginning of each year. The school has clear expectations for this.

KEEPING SCHOOL INFORMED

Good liaison between home and school is essential. It is important teachers know of any physical or emotional upsets which could affect your child during the day. Teachers would appreciate a visit, phone call or email to keep them informed.

LIBRARY

We have a well equipped computerised Library, with weekly class times allocated. The Library is also open most lunchtimes.

LOST PROPERTY

It is important that all articles of clothing and belongings are clearly named. When unmarked clothing is found, it goes into the lost property bin and is available to both parents and children. Unclaimed items will be regularly donated to a charity shop.

MOTEC

Years 7 and 8 students attend MOTEC at Parklands School, Motueka weekly. They travel by bus. MOTEC teachers advise the children of their requirements during the year and inform parents on children's progress at the middle and end of the school year. Students must wear covered shoes and take a water bottle.

NEWSLETTERS

These are posted fortnightly and include dates of upcoming events. Regular updates are added to the web site: www.mapua.school.nz or Facebook.

PARENT HELP

The school would like to encourage parents to participate in the life of the school. You may be interested in helping in classrooms, processing library books, supervision and/or transport on class trips, attending sports and open days, assemblies, social occasions, coaching or helping with sports activities or attending camps.

Reporting to Parents

The school operates an open door policy which means teachers are happy to make arrangements with you to discuss pupil progress and concerns as the need occurs.

School Hours

Morning session:	8.50 am	-	10.30 am
	11.00 am	-	12.25 pm
Afternoon session:	1.20 pm	-	2.45 pm

Stationery

Children are issued with a list of required stationery at the end of each year to be purchased for the following year. These lists also include the costs of items like MOTEC, Steps to Literacy, Mathletics etc. Prices vary between teams.

Sun Smart

Our school operates a Sun Smart policy. Children must wear a full brimmed hat during Terms 1 and 4. We encourage students to have sunscreen applied before coming to school and to have a tube in their school bags.

Swimming

During the summer swimming is a compulsory part of the school programme. Please ensure children bring their togs each day. If they are unable to swim for any reason the teacher should be informed.

Pool keys can be purchased by families for use during the season. These will be available from the office and the cost will be advised at the time they are available. A charge will be made to replace lost keys.



Mapua School Enrolment Scheme

The Enrolment Scheme has been drawn so that it includes the whole land parcels of addresses within the scheme's boundary roads, instead of a buffer from the road centre line which has been used previously for mapping purposes. The previous enrolment scheme description used boundaries such as "the Ruby Valley village settlements" which can be subjective and open to interpretation. Because of the subjective nature of the old description a new description has been written defining the roads which make up the schemes boundary. This proposed description would give a more precise definition as to which addresses are within or outside the home zone.

Home Zone Description

The Home Zone takes addresses on both sides of the boundary roads mentioned in the description unless otherwise stated.

Starting from the corner of The Coastal Highway (SH 60) and Mapua Drive, the home zone follows:

- North-East on Mapua Drive until Higgs Road
- South-East on Higgs Road until Aranui Road (including Citrus Grove)
- North-West on Aranui Road until Stafford Drive (including down to 1 Aranui Road, Toru Street, Langford Drive, Tahi Street, Iwa Street, and the side streets off these roads)
- North on Stafford Drive until Pine Hill Road (including Warren Place, Tait Street, and Broadsea Avenue)
- West on Pine Hill Road and then Pine Hill Road West until Pomona Road (including Stafford Drive north of Pine Hill Road, up to 54 Aporo Road, Brabant Drive, Van Beek Place, and Admirals Way)
- North-West on Pomona Road until Awa Awa Road
- South-West on Awa Awa Road until the end of Awa Awa Road (excluding Suncrest Drive, Westmere Drive, and Amber Rise)
- From the end of Awa Awa Road goes across the northern boundary of 176, 196, and 208 Stagecoach Road until Stagecoach Road
- South-East on Stagecoach Road until The Coastal Highway
- South on the Northern side of The Coastal Highway (SH60) until Mapua Drive

Mark Bruce-Miller
Chairperson
Board of Trustees

Neil Chalmers
Principal

Date: 27/03/2018

Mapua School Enrolment Scheme (February 2018)

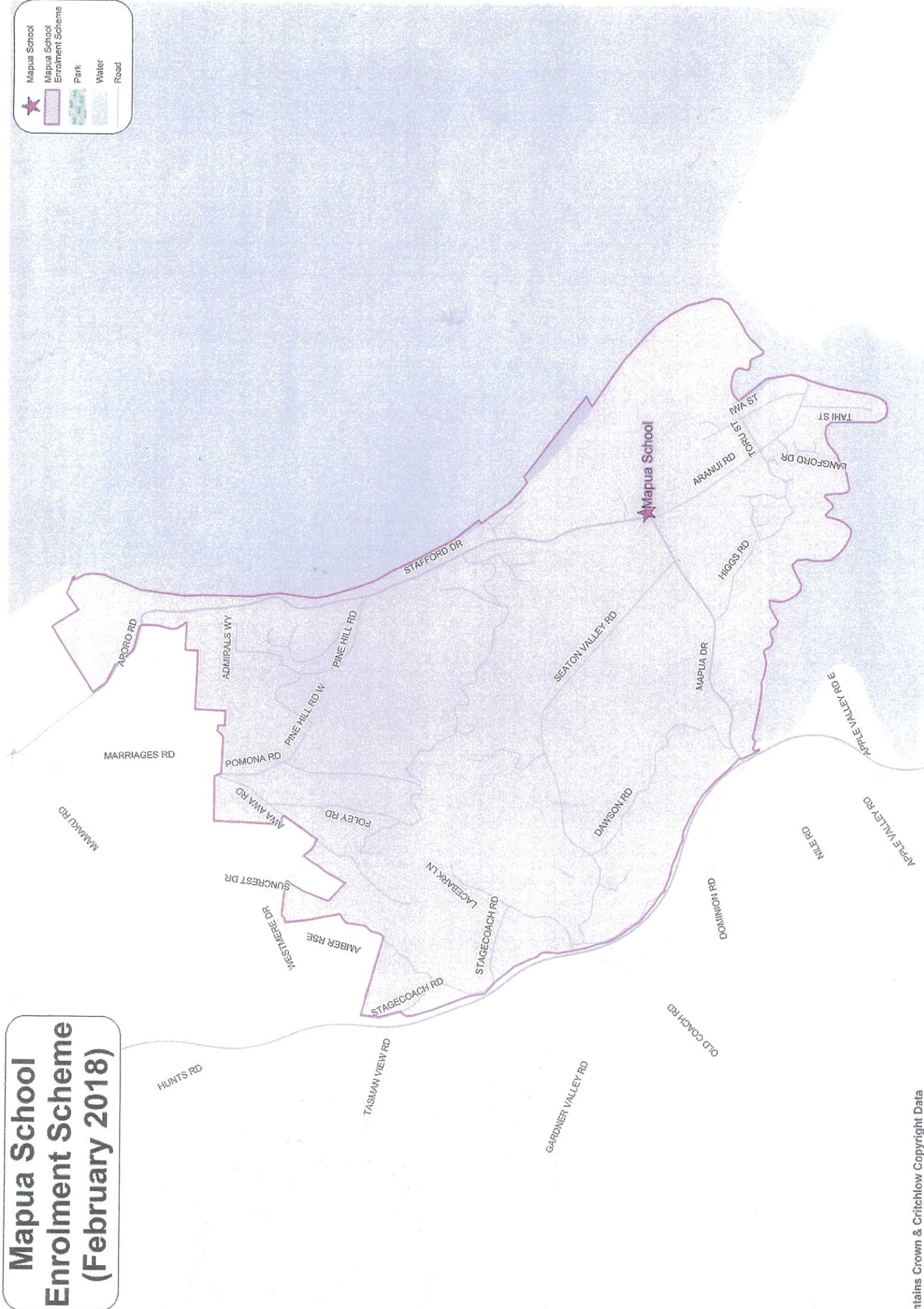

Contacts

Phone: 540 2806
(This also has dedicated absence line where messages can be left)

Email: admin@mapua.school.nz

Address: 4 Stafford Drive
Māpua 7005
Nelson