

TRAWL NAVIGATOR

Contents

Legal	4	Configuring the Echo Sounder	25
History	4	About the Automatic Range Mode	27
Copyright	4	Applying Offsets to Measurements	28
Disclaimer	4	Testing Measures	29
		SD Card Recording	31
		Saving a Configuration on Mosa2	33
		Exporting Sensor Configuration	35
		Importing a Sensor Configuration	36
Introduction and Presentation	5		
Introduction	6		
Applications	6		
Safety Guidelines	8		
Description	8		
System Compatibility	8		
Firmware and Features	9		
Technical Specifications	10		
Main Parts	12		
Operational Mode Indicator	14		
		System Configuration and Display	38
		Adding the Sensors to the Receiver	39
		Adding the Sensors to the Receiver	39
		Configuring Sensor Settings	40
		Configuring Data Display in Scala2	42
		Replaying Data from A2S Files	45
Sensor Configuration	16		
Connecting the Sensor to Mosa2	17		
Battery Information	20		
Diagnostic Information	21		
Configuring the Trawl Node	22		
Configuring the Uplink Frequency and Power	24		
		Installation	47
		Installing the Sensor on the Trawl	48
		Maintenance and Troubleshooting	50

Charging the Sensor with the Dock	51
Cleaning the Sensor	52
Maintenance Checklist	53
Troubleshooting	54
Mosa2 does not open due to error message	54
Sensor does not connect correctly with Mosa2	
when using the Configuration Cable	55
The echogram has a lot of interference	56
Support Contact	57

Appendix	59
Frequency Plan	59

Index	a
--------------	----------

Legal

History

V1	11/08/22	First release
----	----------	---------------

Copyright

© 2022 Marport. All Rights reserved.

No part of this document may be reproduced, stored in a retrieval system or transmitted in any form by any means; electronic, mechanical, photocopying or otherwise, without the express written permission from Marport. “Marport”, the Marport logo and Software Defined Sonar are registered trademarks of Marport. All other brands, products and company names mentioned are the trademark and property of its respective owners only. Marport is a division of Airmar Technology Corporation.

Disclaimer

Marport endeavors to ensure that all information in this document is correct and fairly stated, but does not accept liability for any errors or omissions.

The present user guide is applicable for the following versions:

- Mosa2: 02.11.x
- Scala2: 02.10.x

Introduction & Presentation

Introduction and Presentation

Get a basic knowledge of the sensor.

Introduction

Marport's Trawl Navigator is a high-definition netsonder, designed to operate on the trawl headline.

It is suited for bottom trawling and will offer better performance on trawls with a small vertical opening.

In order to efficiently follow the trawl descent, echogram ranges are configurable from 5 to 160 meters. Moreover, the sensor includes an automatic range mode: the sensor can automatically switch to lower ranges of 20, 10 and 5 meters to get sharper pictures, proving to be particularly useful when fishing close to the bottom.

In addition, the sensor can measure the temperature, depth, pitch and roll.

The Trawl Navigator is available in three sizes: XXL with 4 batteries for a longer battery life, XL with 2 batteries and Stubby with 1 battery.

Applications

Here are examples of data received by the Trawl Navigator in Scala2.

The image below shows the display of data received from a Trawl Navigator installed on the headline. Pollocks can be identified close to the bottom.

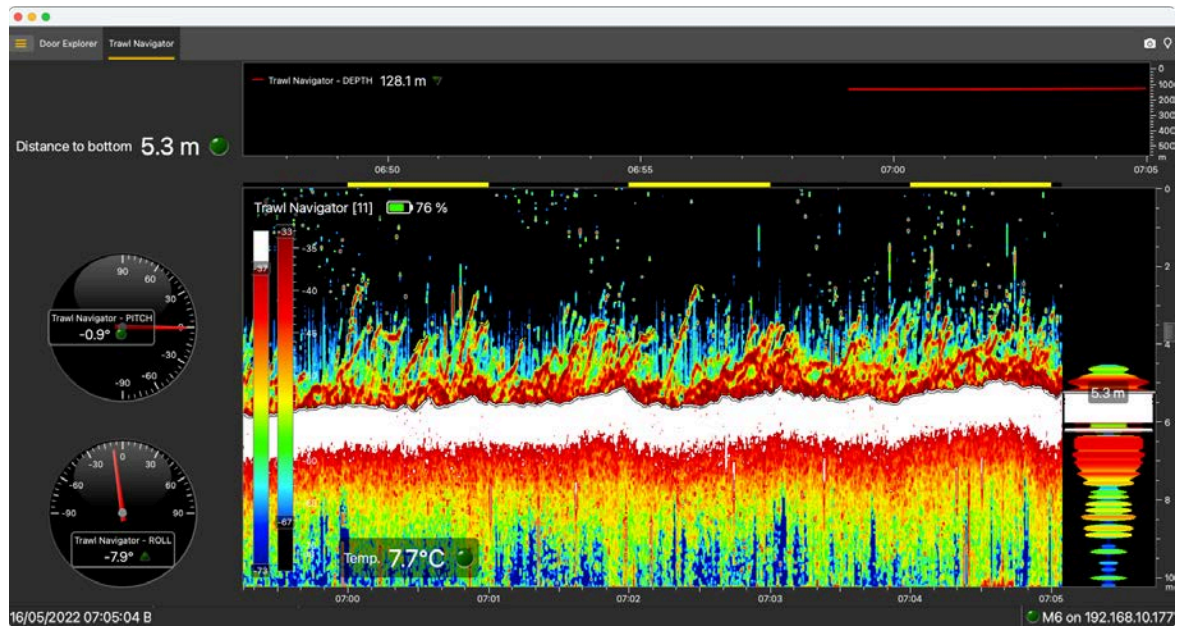

In this second example, the sensor automatic range mode is activated. The range of the sounding is automatically reduced when the sensor gets closer to the bottom, in order to have better quality images.

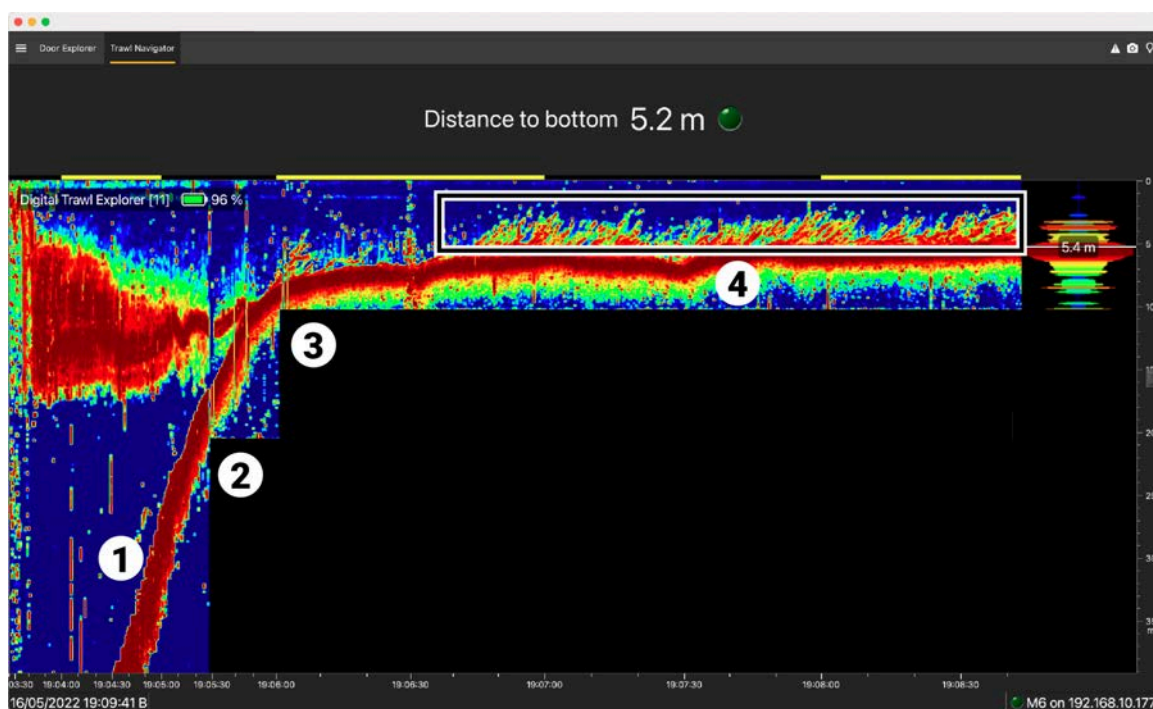

1. Initial range (80 meters) / 2. Switch to a 20-meter range / 3. Switch to a 10-meter range / 4. Target detection: pollocks

Safety Guidelines

! **Important:** To ensure proper and safe use of this equipment, carefully read and follow the instructions in this manual.

Description

System Compatibility

The Trawl Navigator is compatible with the following versions of Marport's software and equipment.

Mosa2	02.11.08 or later
Scala2	02.10.x or later
Mx receiver firmware	08.04.x or later

Dock	01.01.00 or later
-------------	-------------------

Firmware and Features

This section describes the firmware and features that must be configured on MASP to set up the sensor.

To be operational, the sensor needs to be configured with two files:

- a firmware file (*.A2F): it is the firmware of the sensor,
- an application file (*.A2A): it defines the sensor features and options.

These files are generated via MASP.

See for guidance on how to complete the following items and download the firmware and application files.

Firmware

The latest version of the firmware is available for download on MASP.

Compatibility: F450-02.02.x and after

Features and Options

The features and options are configurable according to the type of hardware and customer's choices.

Features	<ul style="list-style-type: none"> • Product name: Manually entered. • Application: Trawl Navigator • Body: Stubby, XL, XXL • Battery capacity (not configurable): <ul style="list-style-type: none"> ◦ Body Stubby : 1 pack ◦ Body XL: 2 pack ◦ Body XXL: 4 pack
Sounding Options (non-editable)	<ul style="list-style-type: none"> • Up • Down

Misc. options	<ul style="list-style-type: none"> • SD Card Log: records a log of the sensor activity. This option is useful for troubleshooting support. • Extended Life Time: under development
Measures	<ul style="list-style-type: none"> • Battery (always activated) • Pressure (depth) • Temperature • Pitch • Roll • Depth

Technical Specifications

Uplink frequency	30 to 60 kHz
Range to vessel	up to 2500 m*
Data update rate	<ul style="list-style-type: none"> • 5-meter range: Echogram @0.15 s - temperature, depth, pitch, roll, battery level @5.4 s • 10-meter range: Echogram @0.3 s - temperature, depth, pitch, roll, battery level @5.95 s • 20-meter range: Echogram @0.59 s - temperature, depth, pitch, roll, battery level @5.9 s • 40-meter range: Echogram @0.76 s - temperature, depth, pitch, roll, battery level @3.8 s • 80-meter range: Echogram @0.81 s - temperature, depth, pitch, roll, battery level @4.05 s • 160-meter range: Echogram @0.92 s - temperature, depth, pitch, roll, battery level @4.6 s
Depth range	up to 1700 m
Depth resolution	0.1 m with 0.1% of the full scale
Echogram range	5 (auto) / 10 (auto) / 20 (auto) / 40 / 80 / 160 meters
Pitch and roll range	-64° to +63°
Pitch & roll accuracy	+/- 1°

Temp measurement range	-5° C to +25° C
Temp accuracy	±0.1° C
Typical battery life †	<ul style="list-style-type: none"> • XXL: Up to 96 hours • XL: Up to 48 hours • Stubby: Up to 24 hours
Battery type	Lithium-Ion
Weight in air (with housing)	<ul style="list-style-type: none"> • XL: 15.1 kg • Stubby: 10.8 kg
Weight in water (with housing)	<ul style="list-style-type: none"> • XL: 3.3 kg • Stubby: 3 kg
Warranty	2 years (Sensor & Battery) **

*Reference only. Depends on communication settings and transmission conditions /

† Depends on sensor uplink power and options. Lifetime has been estimated with a uplink power at 33%. / ‡ Based on average charging time. / **Marport Standard Marine Limited Warranty

Dimensions

XL version

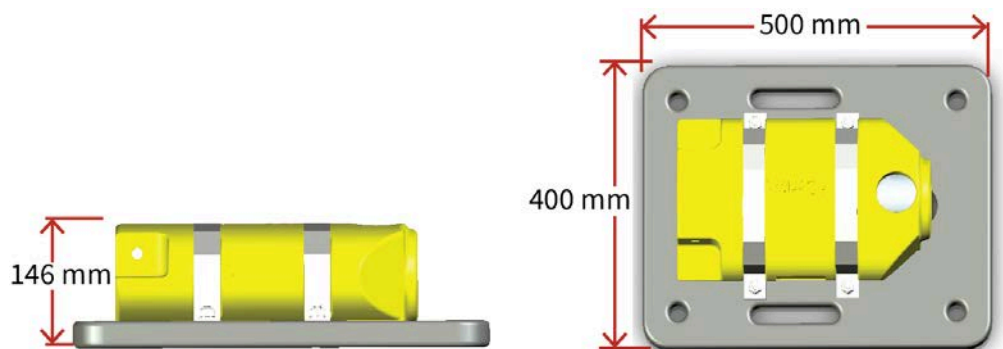

Stubby version

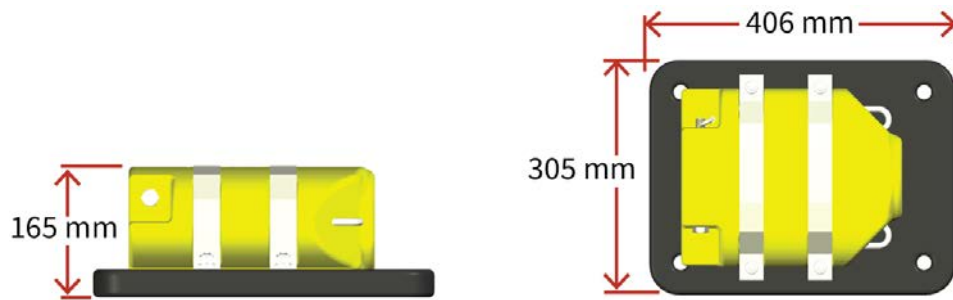

Main Parts

External View

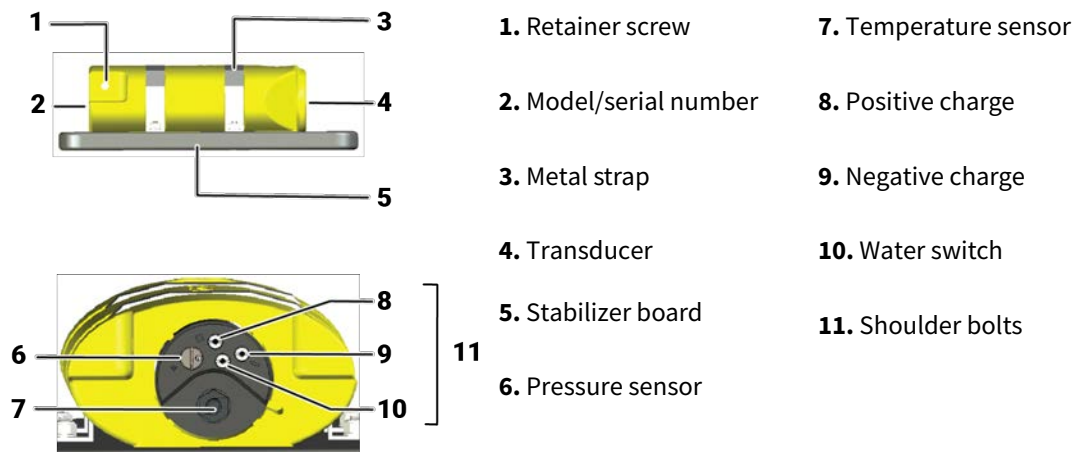

Exploded View

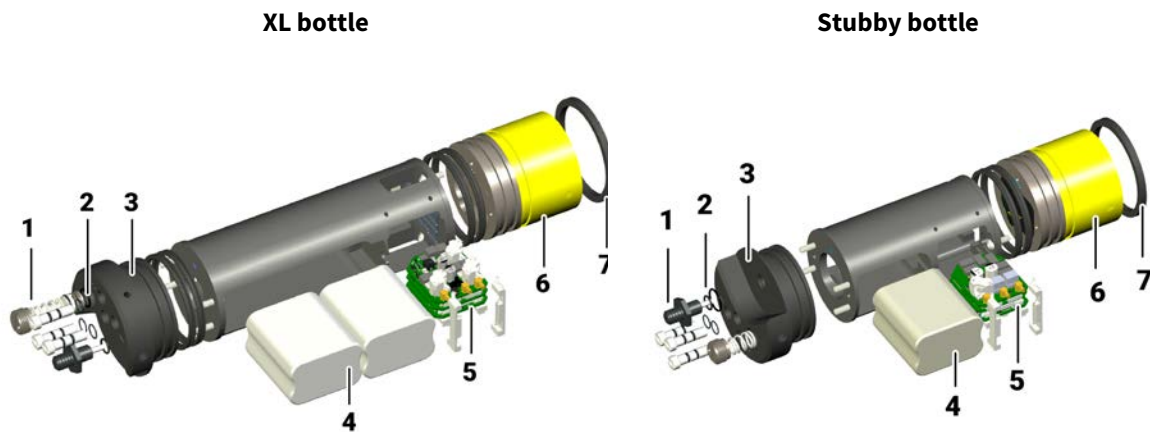

1. Sensors / 2. O-ring seals / 3. End cap / 4. Batteries / 5. A2S PCBA / 6. Transducer / 7. Retainer ring

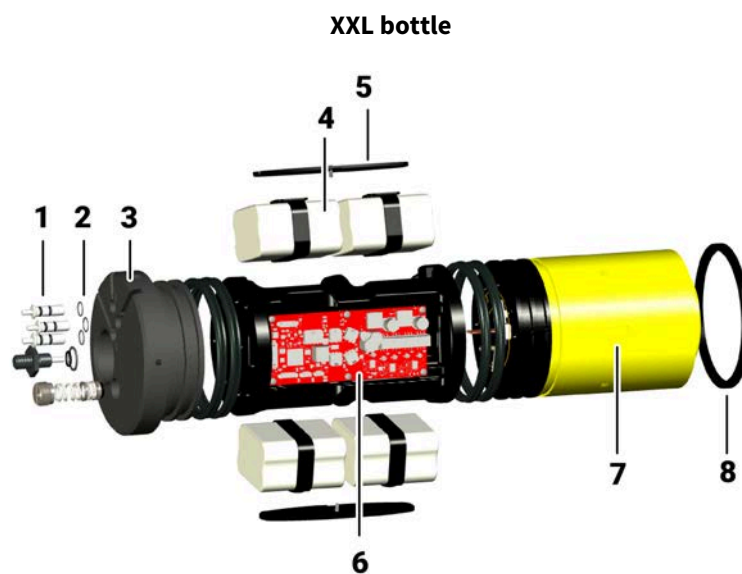

1. Sensors / 2. O-ring seals / 3. End cap / 4. Batteries / 5. Battery retainers / 6. A2H PCBA / 7. Transducer / 8. Retainer ring

PCBA Connectors

The Trawl Navigator has the following PCBA versions:





- A2S Gen 4 and after with stubby and XL bottles,
- A2H Gen 2 and after with XXL bottle.

A2S PCBA

A2H PCBA

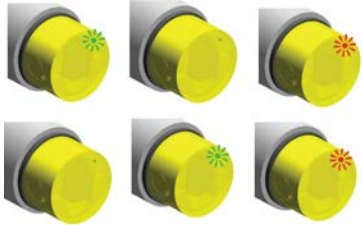
Operational Mode Indicator

A LED on the sensor's transducer indicates the operational mode of the sensor.

State	Situation	LED
Starting	<ul style="list-style-type: none">• Sensor has been switched on in water or with water switch.	 <ul style="list-style-type: none">• Startup sequence: LED blinks green/off/red/off/green/red• Then, fixed green for a 1 sec.
Running	<ul style="list-style-type: none">• Sensor is in water.• Water switch is on.	 <ul style="list-style-type: none">• For 1 min.: LED blinks red at the beginning of each uplink communication cycle.• Or, LED blinks green / red if the product configuration is not valid.
Configuring	<ul style="list-style-type: none">• Sensor is out of water.• User is testing and configuring using a Configuration Cable• Sensor turns off after 10 min. without test or configuration operation.	 <p>LED blinks green.</p>
Charging	<ul style="list-style-type: none">• Charger plug is connected.• User is configuring at the same time via the Dock.	

State	Situation	LED
		<ul style="list-style-type: none"> • LED blinks red. • LED is fixed red after 10 sec. if connected to a charger other than the Dock.
On deck	<ul style="list-style-type: none"> • Sensor has been hauled on deck • The virtual water switch is on • The sensor is locked in a low power state to not switch into running mode 	 <p>LED blinks green every 4 sec.</p>

Sensor Configuration

Sensor Configuration

Learn how to configure the sensor settings.

Connecting the Sensor to Mosa2

To configure the sensor, you need to connect it to Mosa2 application, using either the Dock or the Configuration Cable.

Using a Dock Charger Plug



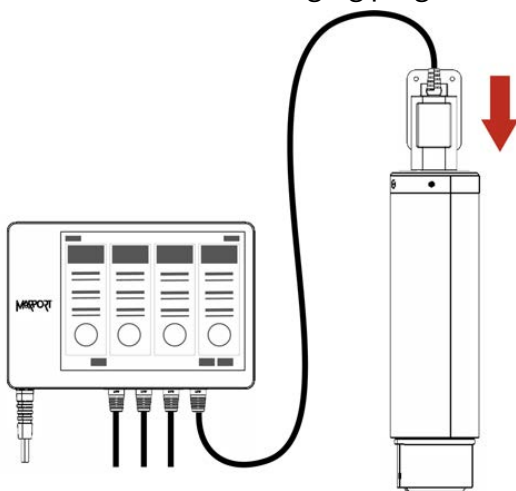

Tip: Refer to Dock user manual to have more details about the use of this product.

1. Connect one Dock charging plug to the sensor's endcap.

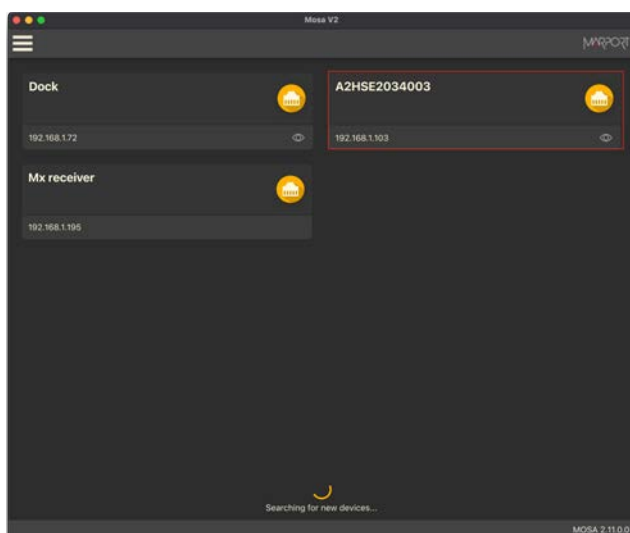

2. Mosa2 discovery page opens. The sensor is displayed.



- Click  to open the sensor configuration page.
- Click  to show the deploy animation on the charger plug for 30 seconds.

Using the Configuration Cable

Simply connect the Configuration Cable from the computer to the sensor to display the sensor configuration page on Mosa2.



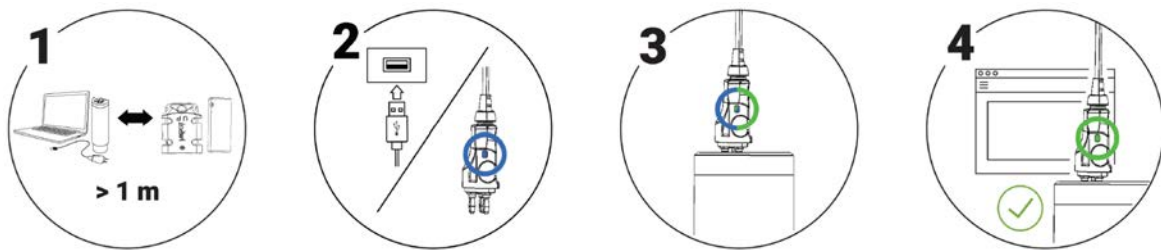

Tip: Refer to the **Configuration Cable Quick Reference Guide** for more details about the use of this product.

1. Move other electrical devices minimum 1 m away from the computer.
Mosa2 opens automatically and the startup wizard is displayed. The LED on the plug is solid blue.
3. Connect the three-pin plug to the sensor.
The LED on the plug blinks alternatively blue and green.
4. Wait a few seconds. The configuration page of the sensor is displayed on Mosa2.
The LED on the plug is solid green.



You can now configure the sensor.

 **Note:** You can keep the Configuration Cable continuously connected by USB, and virtually eject or connect it. When no sensor is connected to the Configuration Cable, click **Menu**  > **Eject Config Plug** or **Connect Config Plug**. When ejected, you come back to the discovery page. It stays disconnected until you virtually connect to it or manually disconnect then connect it.

Battery Information

The battery lifetime is displayed on the first page.

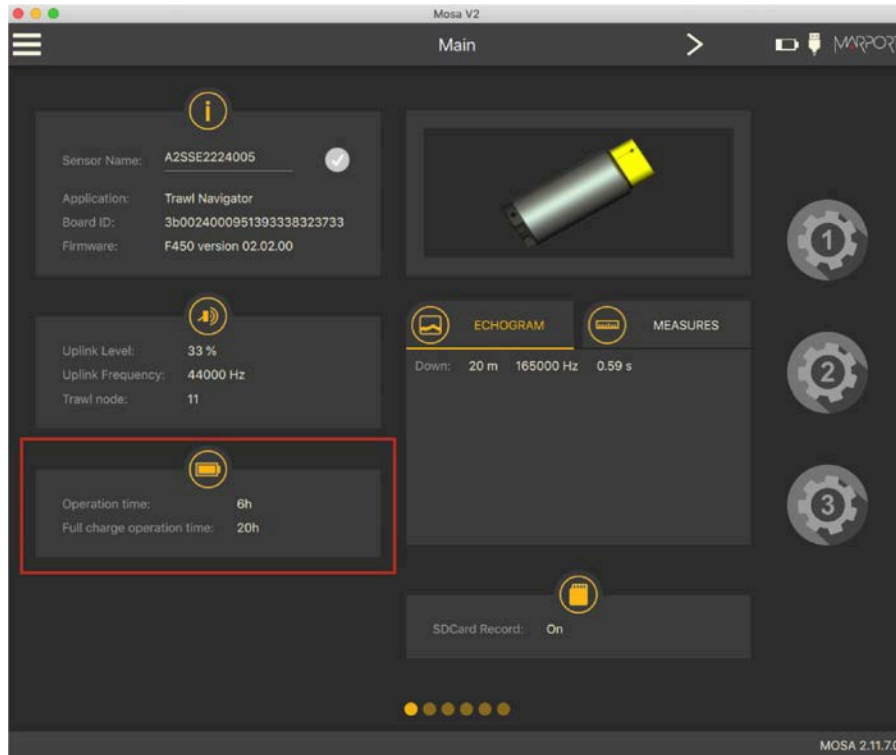

You can also check the battery level at anytime from the top bar:

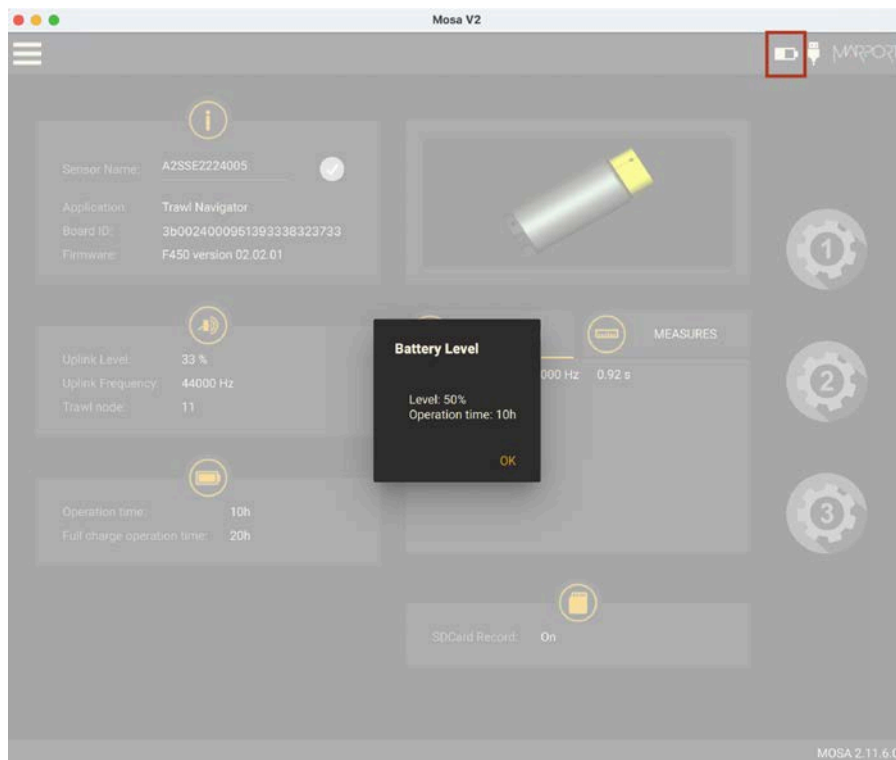

Note: When you change settings such as the uplink power or sounding range, it affects the battery level and remaining lifetime. The battery information will update after the sensor has been switched on and operating for 10 minutes.

Diagnostic Information

Scala2 and Mosa2 applications warn the user in case of water ingress in the sensor.

Note: Diagnostic information is available for Marport Pro sensors (A2S and A2H PCBA versions), from the firmware version **F450-02.02.00 or later** and Mosa2 version **02.11.07**.

In case of water ingress in the sensor, alarms are displayed in Scala2 Virtual Charger Room, in Mosa2 and on the charger plug when connected to the sensor.

- Mosa2 displays a dialog at the start of the application and warning icon in the toolbar and diagnostic page:

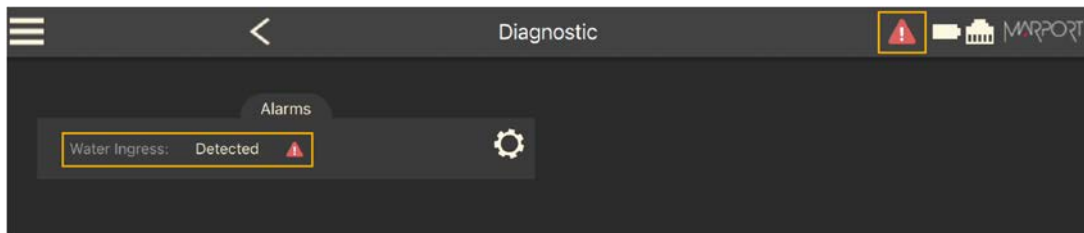

- The charger plug displays a warning icon:



When the alarm appears, take the sensor out of water immediately and contact Marport support.



Warning: In case of water ingress in the product, do not charge it: battery may vent or rupture, causing product or physical damage.

Configuring the Trawl Node

You need to give a trawl node to the sensor. It is the number corresponding to the position of the sensor on the trawl.

The trawl nodes corresponding to the positions on the headrope and footrope are the following:

Trawl number	Node numbers
Trawl 1	10 to 17
Trawl 2	110 to 117
Trawl 3	210 to 217
Trawl 4	310 to 317

Trawl number	Node numbers
Trawl 5	610 to 617

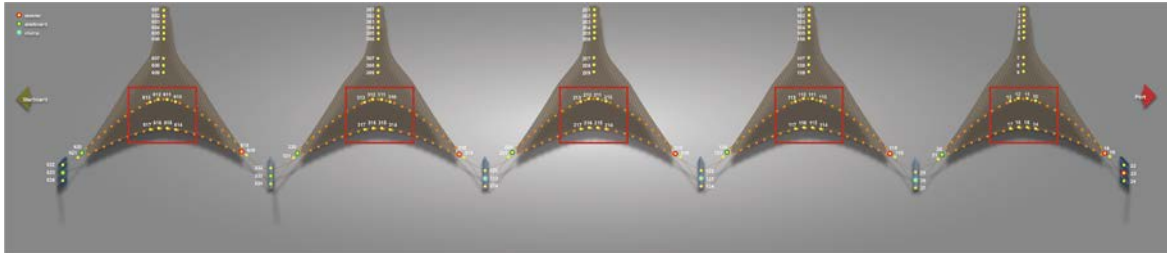

1. Go to the **Communication** page, then click  in **Uplink**.
2. Enter a node according to the position of the sensor on the trawl.

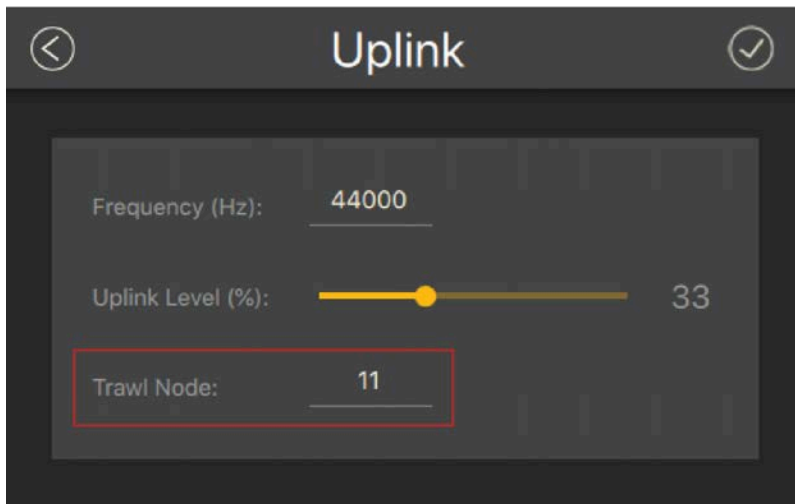

-  **Important:** Make sure to put the same number when adding the sensor to Scala2 receiver page. If not, change it accordingly.



Add Sensor Product	
Add from Marport Sensor Configuration Tool	
1. Product Category	Trawl Explorer
2. Product Name	Trawl Navigator
3. Trawl Gear Location	011

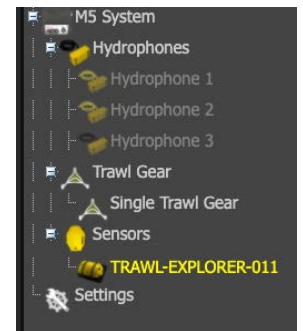

3. Click

Configuring the Uplink Frequency and Power

Configure the settings of the communication link between the sensor and the vessel.

1. Go to the **Communication** page, then click  in **Uplink**.

Uplink

Frequency (Hz): 44000

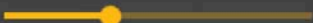
Uplink Level (%):  33

Trawl Node: 11

2. Enter a frequency for the communication with the vessel. Default is 44000 Hz.
3. Drag the slider to change the power of the uplink signal.



Note: A higher level of uplink power reduces the battery lifetime.



Recommend- ed uplink powers	Conditions	Estimated battery life
33%	Works for most conditions.	XXL: Up to 96 hours / XL: Up to 48 hours / Stubby: Up to 24 hours

Configuring the Echo Sounder

Configure the echo sounder settings of the Trawl Navigator.

1. Go to the **Echo Sounder** page.
2. To select the direction of the sounding, click  in **Sounding Mode**, then choose a **Mode** between **Down** or **Up**.

3. Go back to the page, then click  in **Down Sounding** or **Up Sounding**, depending on the **Sounding Mode** that was configured.

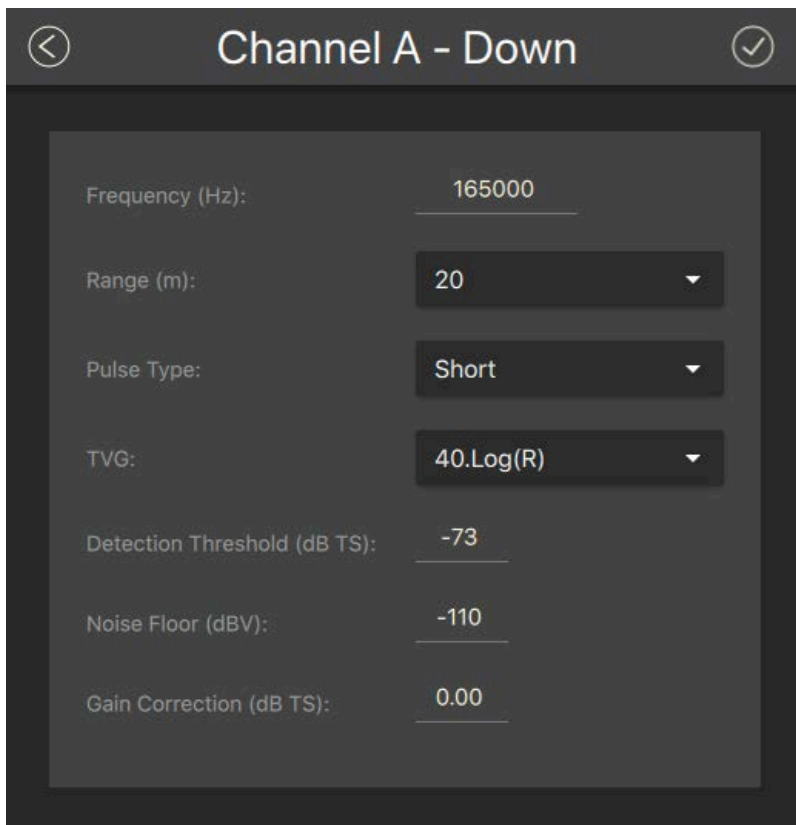

Frequency (Hz):	165000
Range (m):	20
Pulse Type:	Short
TVG:	40.Log(R)
Detection Threshold (dB TS):	-73
Noise Floor (dBV):	-110
Gain Correction (dB TS):	0.00

4. Set the **Frequency (Hz)** at:
- 165 000 Hz if XL or stubby bottle
 - 100 000 Hz if XXL bottle
5. The **Range (m)** of the sounding is the maximum distance at which targets and bottom can be detected.

 **Note:** We recommend to set the maximum range value when using the automatic range in order to see the sea bottom as soon as possible.

6. The **Pulse Type** is automatically set, depending on the echogram range:
- 5 to 20 m: 100 μ s
 - 40 m: 200 μ s
 - 80 m: 300 μ s
 - 160 m: 500 μ s

7. Select a **TVG** setting to compensate the signal loss in water and have targets or sea bottom displayed in the same color on the echogram, whatever the distance from the sensor:
 - 20 log: focus on bottom or school of fish.
 - 40 log: focus on individual targets.
 - 30 log: compromise between the two above settings.
8. Do not modify the other echo sounder settings.

About the Automatic Range Mode

The sensor has an automatic range mode that is useful to get better quality echograms when the trawl is close to the bottom.

Principle

The range influences the display of echogram images. The smaller the range, the shorter the listening time, which gives better quality images. But the bigger the range is, the lesser the image quality is, because data arrives slower.

You can activate the automatic range mode if you need to get better quality echograms when the trawl is close to the bottom. This mode is recommended when bottom trawling.

The echogram can automatically switch to a 20-meter range when the distance to the bottom is less than 20 meters, to a 10-meter range when the distance is less than 10 meters and to a 5-meter range when less than 5 meters.

The change of range depends on the settings configured on Mosa2.

Mosa2 settings

The following **Sounding Mode** options must be set in Mosa2:

- **Automatic Range** must be activated.
- The **Mode** must be set to **Down only**.
- The **Trawl Opening**:
 - must be lower than 19 meters to be able to switch to a 20-meter range.
 - must be lower than 9 meters to be able to switch to a 10-meter range.
 - must be lower than 4 meters to be able to switch to a 5-meter range.



 **Note:** The trawl opening value sets the minimum distance to see inside the trawl. As a result, if the trawl opening distance is equal or higher than 19, 9 meters or 4, the sensor will not reduce the range respectively to 20, 10 or 5 meters.

 **Note:** If the echosounder is configured with a range of 20 m, the 20 m automatic range is activated by default.

See **Configuring the Echo Sounder (on page 25)** for details about Mosa2 settings.

Applying Offsets to Measurements

You can apply offsets to temperature and depth measurements if the measured values does not correspond to the environment of the sensor.

1. Press command + A or click **Menu**  and click **User Mode > Advanced**.
2. Go to **Measurements** page and click  next to depth or temperature to apply offsets.
3. Enter a target value. Click .

The measured value becomes the same as the target value. The value of the offset is displayed.

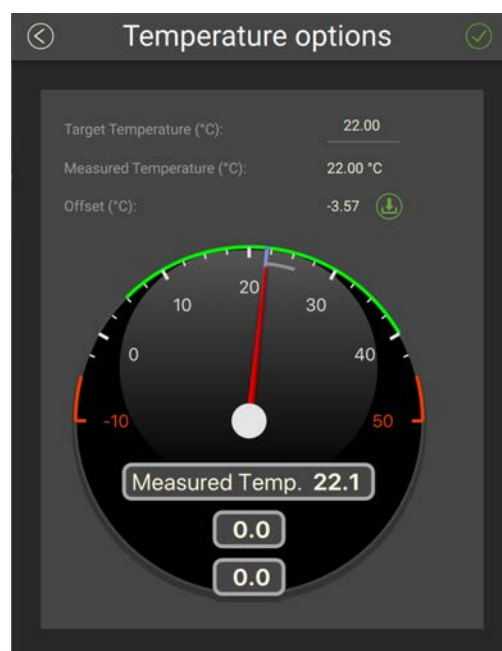
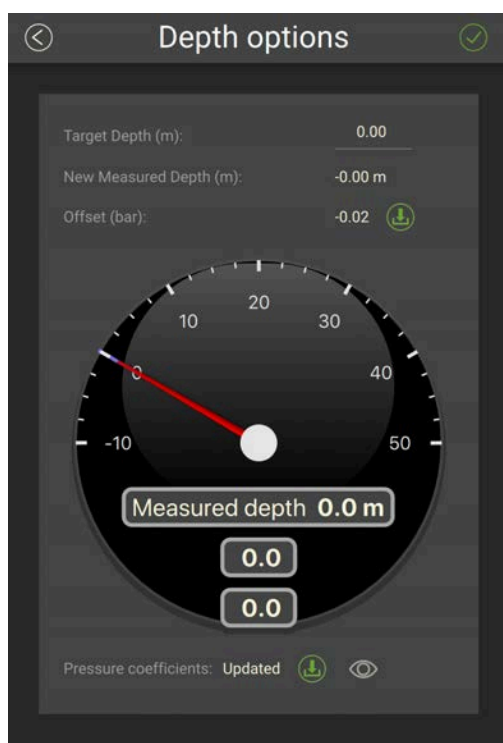

4. If you need to reuse offsets from a previous configuration, click  then select the configuration file (*.A2C).

Testing Measures

You can test the measures taken by the sensor (e.g. battery level, temperature, depth) to check that there are no faults.

You can test the sensor in water or in air. In air, the following measures will be wrong: height, conductivity.

1. Press command + A or click **Menu**  and click **User Mode > Advanced**
2. Go to the **Monitoring** page.

You can check information about the battery, board and sensor.

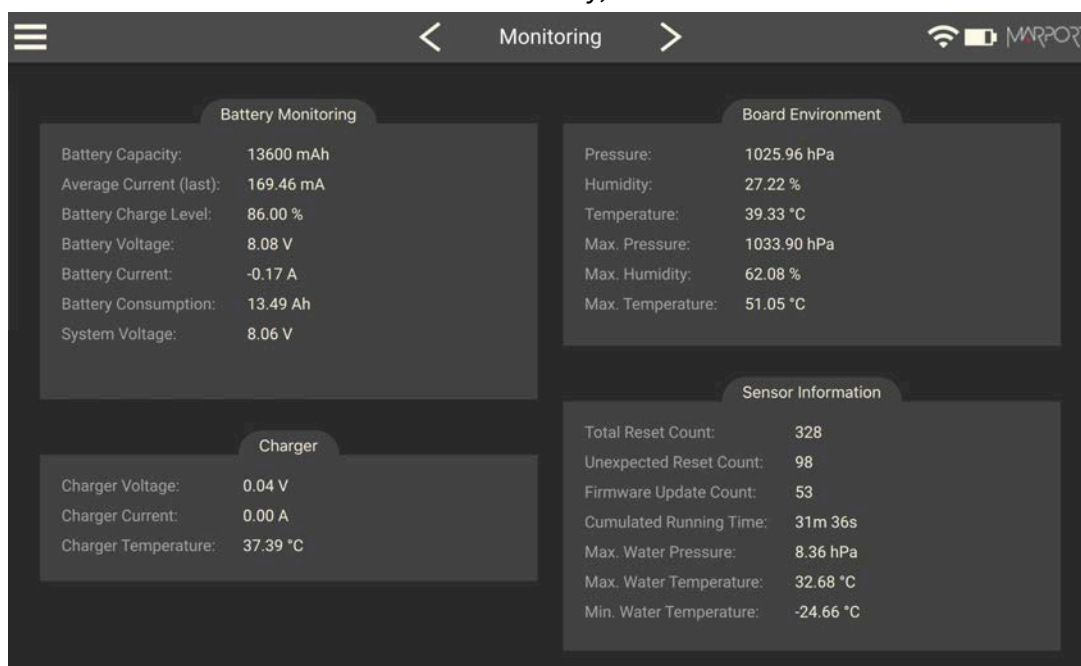

3. Go to the **Measurements** page.

You can see the values of the activated measures, such as depth, temperature. If the sensor is working correctly, measures are updating.

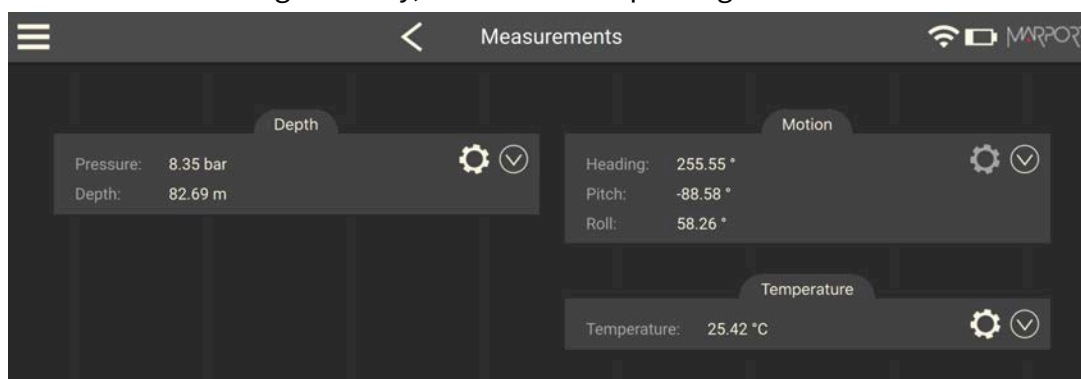

4. Click  to check and, if necessary, adjust data measured by the sensor:
- **Depth:** Place your sensor on a desk or on the ground and enter 0 in **Target Depth**.
 - **Temperature:** Enter the estimated temperature of your environment.

SD Card Recording

This topic explains the SD card recording feature (this feature is optional).

Overview

Data recorded on the SD card are in higher resolution, with a higher rate.

You can see on Mosa2 main page if the SD card recording feature is activated:

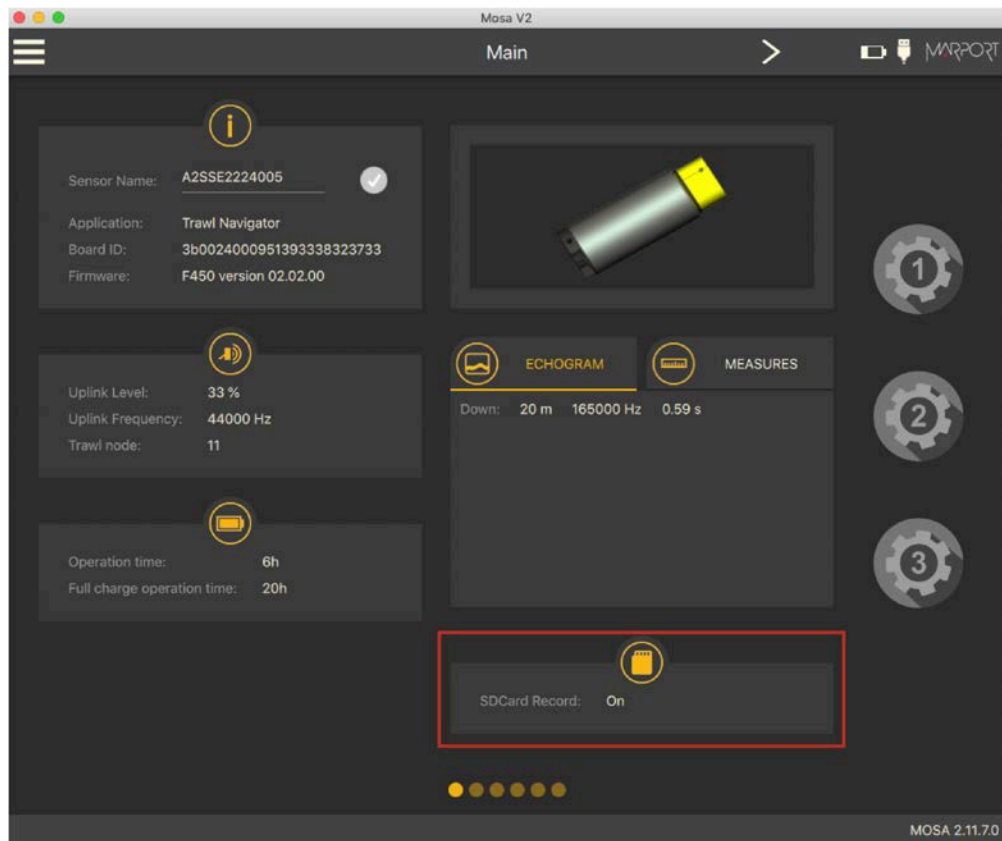

Additional settings

We recommend to activate the support logs to help support teams for error diagnosis.

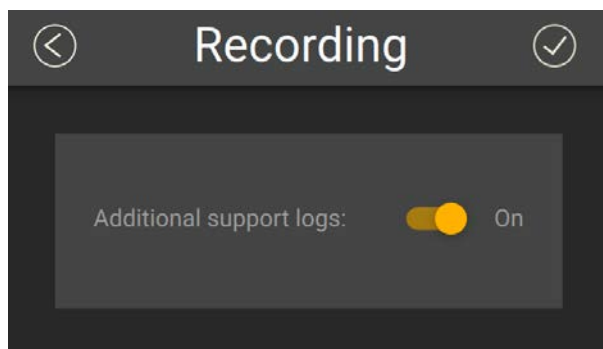

1. Go to the **Communication** page, then click  in **Recording**.
2. Activate **Additional support Log**.



Getting data from the SD card

Only the last 99 recorded sensor data files and last 99 battery files are displayed. Two types of files are on the SD card:

- Files containing measures recorded by the sensor. Their name begins by "450". These data are more precise and recorded more often than data received on the receiver. One file corresponds to a tow (time between entering and leaving water). The recording date displayed in the second column is synchronized with your computer time.
- BATT = Files created when the sensor is charging (1 file per charging cycle). They are useful for support teams for troubleshooting.

 **Note:** The first time the sensor connects to Mosa2 or if the sensor desynchronizes, a clock with a warning icon  is displayed in the top toolbar. Click it to synchronize the time of the SD card with the computer's time.

1. Press command + E or click **Menu**  and click **User Mode > Expert**.
2. On the first page, click  in **SDCard Record**.

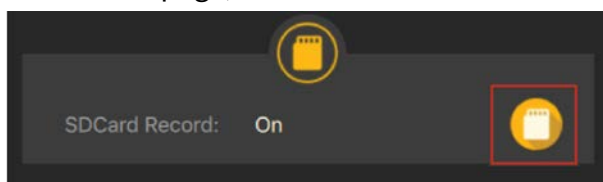

Recorded files are displayed. Click the title of the columns to sort them by their name, date or size.

Name	Date	Size
450_001.A2S	2021/09/28 13:05:58	4377KB
450_002.A2S	2021/09/28 13:15:18	11948KB
450_003.A2S	2021/09/29 16:10:26	18720KB
450_004.A2S	2021/09/30 08:30:28	1999KB
450_005.A2S	2021/09/30 08:36:12	1712KB
450_006.A2S	2021/09/30 08:45:30	11841KB
450_007.A2S	2021/09/30 08:54:24	7270KB
450_008.A2S	2021/09/30 08:58:08	5656KB
450_009.A2S	2021/09/30 12:32:26	3790KB
450_010.A2S	2021/09/30 12:42:26	1166KB
450_011.A2S	2021/09/30 13:12:12	8422KB
450_012.A2S	2021/10/01 07:35:40	3257KB
450_013.A2S	2021/10/01 07:51:02	182KB
450_014.A2S	2021/10/01 08:13:32	2013KB
450_015.A2S	2021/10/01 09:14:34	237KB
450_016.A2S	2021/10/01 09:21:52	2662KB
450_017.A2S	2021/10/01 12:31:28	2047KB
450_018.A2S	2021/10/01 12:48:16	637KB
450_019.A2S	2021/10/01 12:50:36	1563KB

Free: 59.0GB Total: 59.5GB Last: 44 DOWNLOAD

1. Time of end of towing
2. Memory size of SD card
3. Free memory on SD card
4. Index of the last SD card file written

See **Replaying Data from A2S Files (on page 45)** to learn how to replay these data in Scala2.

Saving a Configuration on Mosa2

You can save different configurations of the sensor to be able to quickly change the configuration when you change your fishing method.

- You have finished configuring the sensor.

You can have up to three different configurations for the sensor. When you change your fishing method, you can apply a corresponding configuration in one click. For example:

- If fishing in shallow water, you can use a configuration with an uplink level of 33%, a short pulse and a short range.
- If fishing in greater depths, you can change for a configuration with an uplink level of 100%, a long pulse and a long range.

1. When you are finished configuring the sensor, for example to use the sensor in shallow water, click one of the wheel icon  on the first page of Mosa2.
The wheel icon becomes orange and the name of the configuration is displayed underneath.
2. In the window that appears, enter a name for the configuration and save it.
The wheel icon becomes orange and the name of the configuration is displayed underneath.

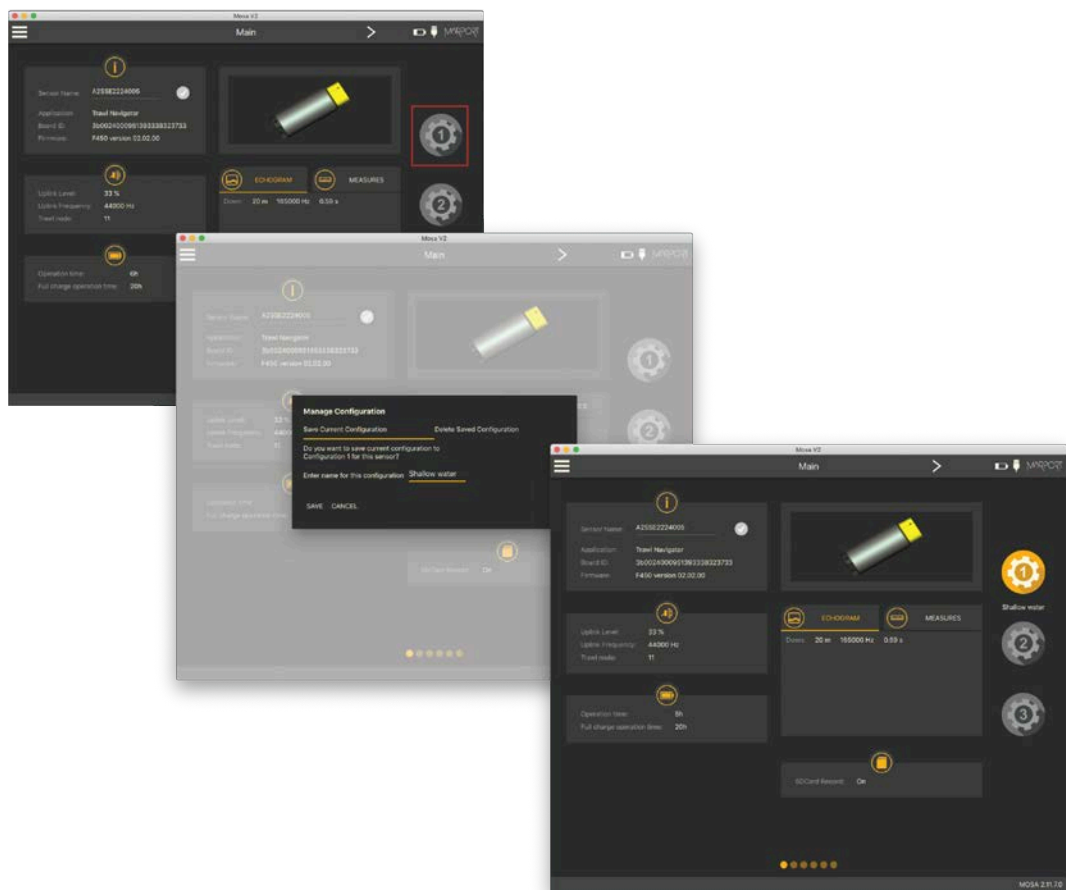

3. To create another configuration, for example this time to use the sensor in deep waters, change the settings of the sensor on Mosa2.

4. When you are finished, click the second wheel icon and save the configuration.

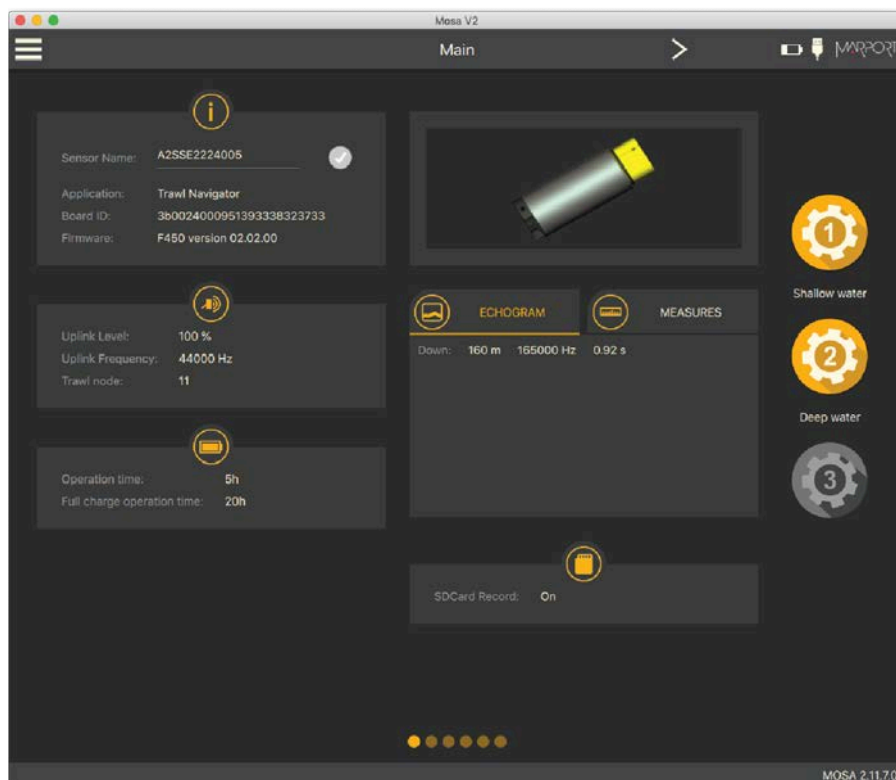

5. If you need to change the sensor configuration back to the first configuration (shallow water), click the corresponding wheel.
- The configuration is applied.
6. If you need to make changes to a configuration:
- Change settings.
 - Maintain the click on the corresponding wheel until the **Manage Configuration** window appears.
 - Click **OK** in **Save Current Configuration**.
7. To delete a configuration:
- Maintain the click on the corresponding wheel until the **Manage Configuration** window appears.
 - Click **OK** in **Delete Saved Configuration**.

Exporting Sensor Configuration

You can export the sensor settings you configured on Mosa2 on a file. You can afterward use this file when configuring a similar sensor.

- You are finished configuring the sensor.

If you have issues with your sensor, send this file to support teams.

1. Click **Menu**  > **Export**.

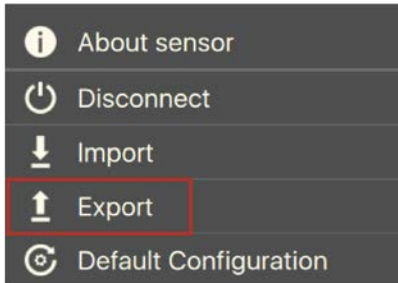

2. From the window that appears, choose a folder on your computer to save the file and click **Open**.

The configuration file is exported and saved on your computer as an A2C file. If you are connected to the internet, it is also automatically sent to MASP in XML and PDF files:

Details

Attachments



A2S

Device

Config

Measurements

Test

#		Size	Name	Date modified (UTC)
<input type="checkbox"/>		371.37 KB	A2HSE2034002_2021-06-30.06.36.2...	2021-06-30 04:36:24
<input type="checkbox"/>		38.21 KB	A2HSE2034002_2021-06-30.06.36.2...	2021-06-30 04:36:20

Importing a Sensor Configuration

You can apply to a sensor a configuration that has already been made on another sensor.

- You have exported a configuration (see **Exporting Sensor Configuration (on page 35)**) and have the *.A2C or XML configuration file.

Only the following settings are imported: trawl node, recording settings (SD card, support logs), communication options (virtual water switch, simulation mode), uplink level and frequency, echo sounder settings.

! **Important:** If the new configuration change the echo sounder settings, you must re-calibrate the sensor for target strength value.

1. Press command + A or click **Menu**  and click **User Mode > Advanced**
2. Click **Menu**  > **Import**.

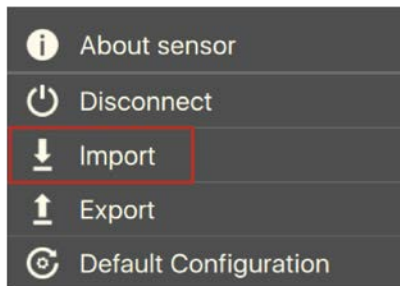

3. From the window that appears, select the *.A2C or XML configuration file.

The configuration is loaded into the sensor.

System Configuration & Display

System Configuration and Display

Learn how to configure the receiver and display the sensor data in Scala2 application.

Adding the Sensors to the Receiver

You need to add the sensors to the receiver in order to display their data on Scala2.

For compatibility details, see **System Compatibility (on page 8)**.

Adding the Sensors to the Receiver

You need to add the sensors to the receiver using the system web page.

1. From Scala2, click **Menu**  > **Expert Mode** and enter the password `copernic`.
2. Right-click the IP address of the receiver at the bottom of the page, then click **Configure Receiver**.
3. From the left side of the receiver page, click **Sensors**.



4. From the page **Add Sensor Product** select:

Add Sensor Product	
Add from Marport Sensor Configuration Tool	
1. Product Category	Trawl Explorer
2. Product Name	Trawl Navigator
3. Trawl Gear Location	011

- a. **Product Category:** Trawl Explorer
- b. **Product Name:** Trawl Navigator
- c. **Trawl Gear Location:** same as defined in Mosa2 (see **Configuring the Trawl Node (on page 22)**).

Configuring Sensor Settings

You need to complete communication settings when you add the sensor to the receiver.

! **Important:** Make sure the settings you enter here are the same as in Mosa2.



TRAWL-EXPLORER-011

Sensor Name

Sensor Name: **1**

Sensor Product: **1**

Sensor Options

Trawl Navigator

Frequency (Hz): **2**

Sensor data

☒ Depth Filter **3**

☒ Temperature Filter **3**

☒ Roll Filter **3**

☒ Pitch Filter **3**

Battery Filter **3**

Echograms Filter **3**

Echogram settings

Sounding Direction: **4**

Sounding Range(m): **5**

Echogram "0" Threshold:

dB / Step:

Steps:

Uplink

Frequency (Hz): **2**

Uplink Level (%):

Trawl Node:

Sounding Mode

Mode: **4**

Trawl Opening (m):

Automatic Range: ☒ On

Channel A - Down

Frequency (Hz):

Range (m): **5**

Pulse Type:

TVG:

1	Sensor name displayed in Scala2 and its features.
2	Enter the same frequency as the one entered for the uplink frequency in Mosa2.
3	Click Configure to change filters applied on incoming data. Filters are particularly useful to reduce interferences on the echogram data.
	<p>Note: Be aware that echogram filters such as Echosounder and Interference Reduction may remove small targets on the echogram.</p>

	 Tip: Please refer to Scala2 user guide for more information about the filters.
4	Select the same sounding direction and range as those set in Mosa2.

Click **Apply** when you have finished.

Configuring Data Display in Scala2

You can display the sensor's measurements and echograms on Scala2 pages.

Connect in **Customize** mode to configure the display of data. From the top left corner of the page click **Menu**  > **Customize** and enter the password `eureka`.

1. Open the control panels and go to the **Mx** tab.
2. To display the echograms, click + hold **Sonar Data** from a Trawl Navigator sensor and drag it to the page display.

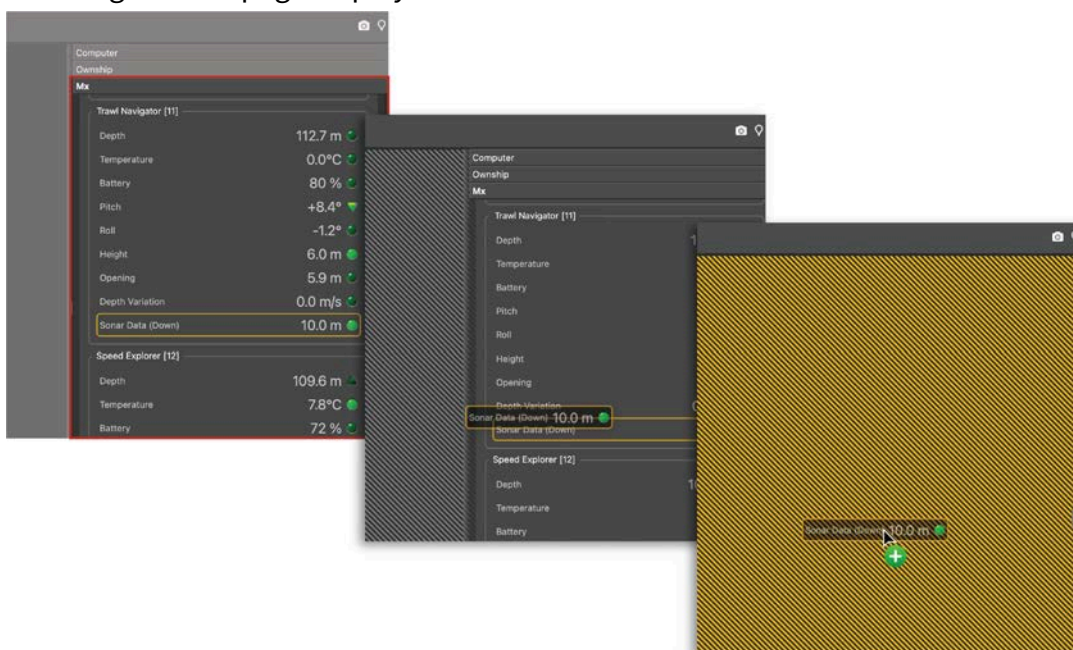

3. Click + hold other data, such as depth, pitch, roll, and drag it as well to the page display.

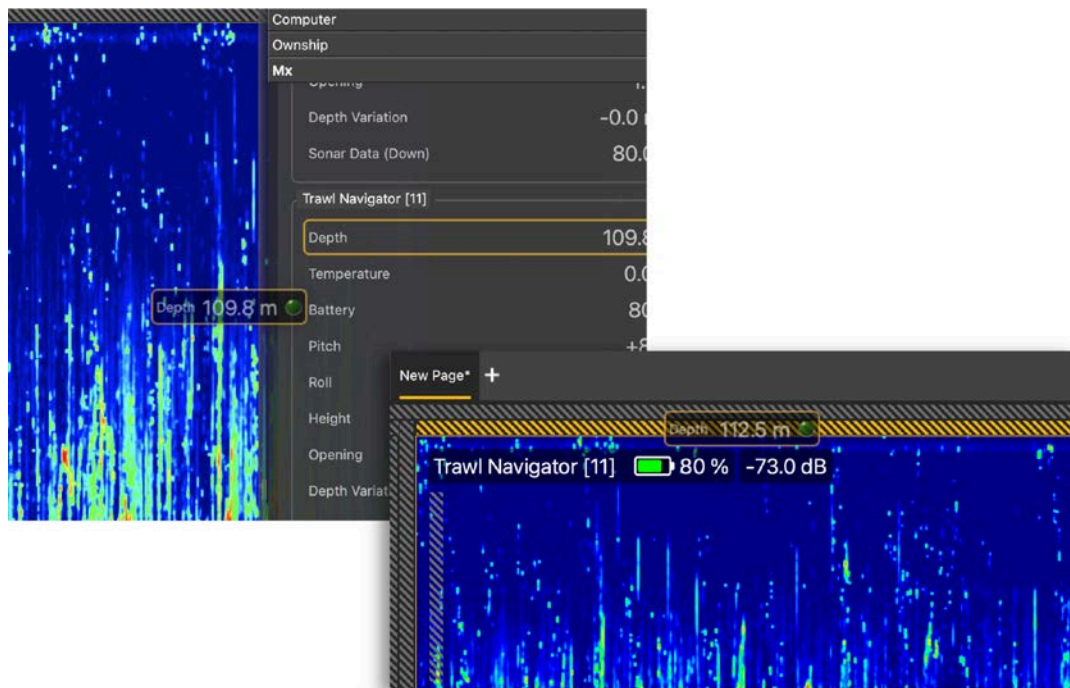

4. Select the type of display.

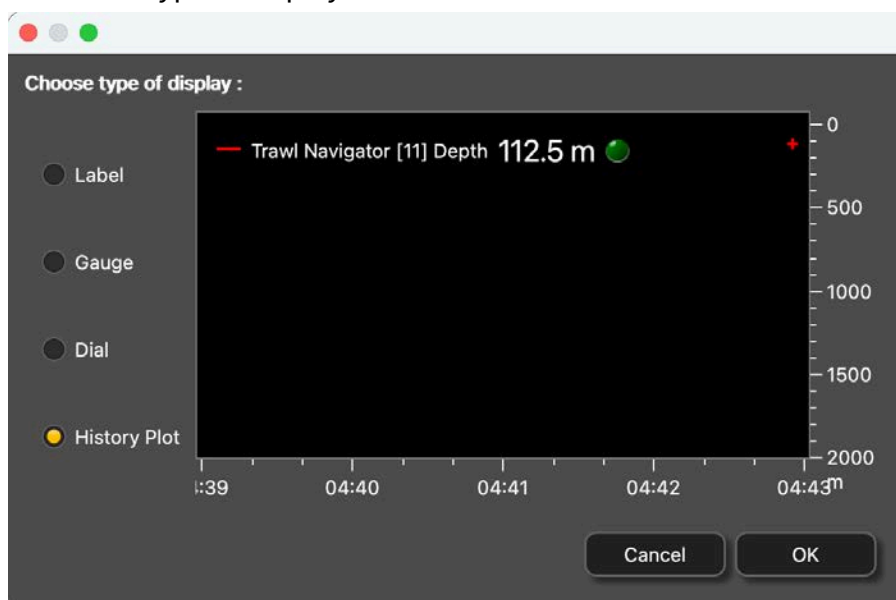

5. Drag the lines around the blocks of data to resize them.

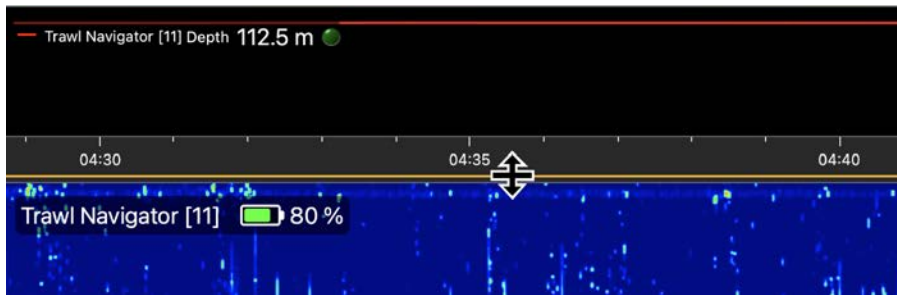

6. Right-click the title or the values of the data to display customization options.

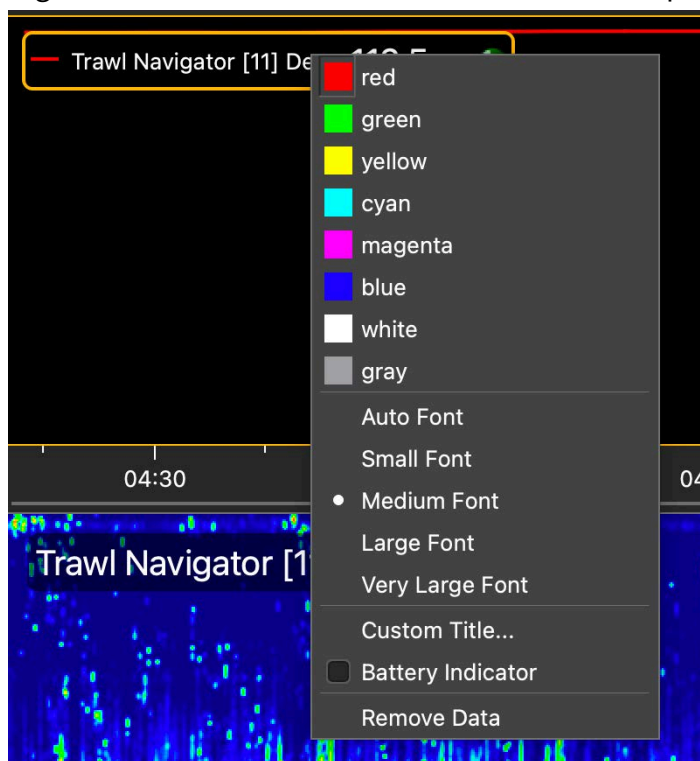

7. To save the changes, right-click the tab with the name of the page and click **Save Changes**.

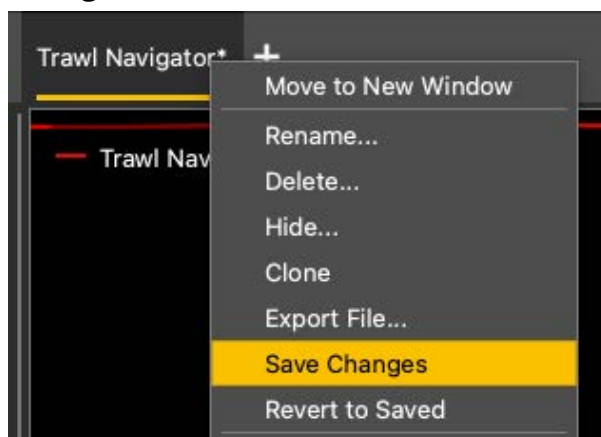

Replaying Data from A2S Files

You can replay data that have been recorded in high definition on the SDS card.



Note: Data in high definition is available only when downloading them from the SD card of the sensors. Data received in Scala2 in live will have a lower definition.

1. Download A2S files from Mosa2
2. Right-click the timeline and click **Change Directory** to choose the source directory where A2S files are stored.

In the replay bar, the recording period of A2S files is displayed in green.

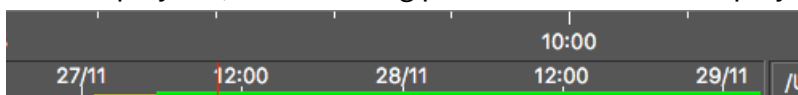

In the control panels, data that were received in live are displayed in the **Mx** panel and data recorded on the SD card are displayed in the **A2S Data** panel.



3. Go to the control panels, then click and drag data from the **A2S Data** panel to a page.

Installation

Installation

Learn how to install the sensor on the trawl gear.

Installing the Sensor on the Trawl

We recommend to install the sensor on the headrope in order to see the trawl opening and fish entering the trawl.

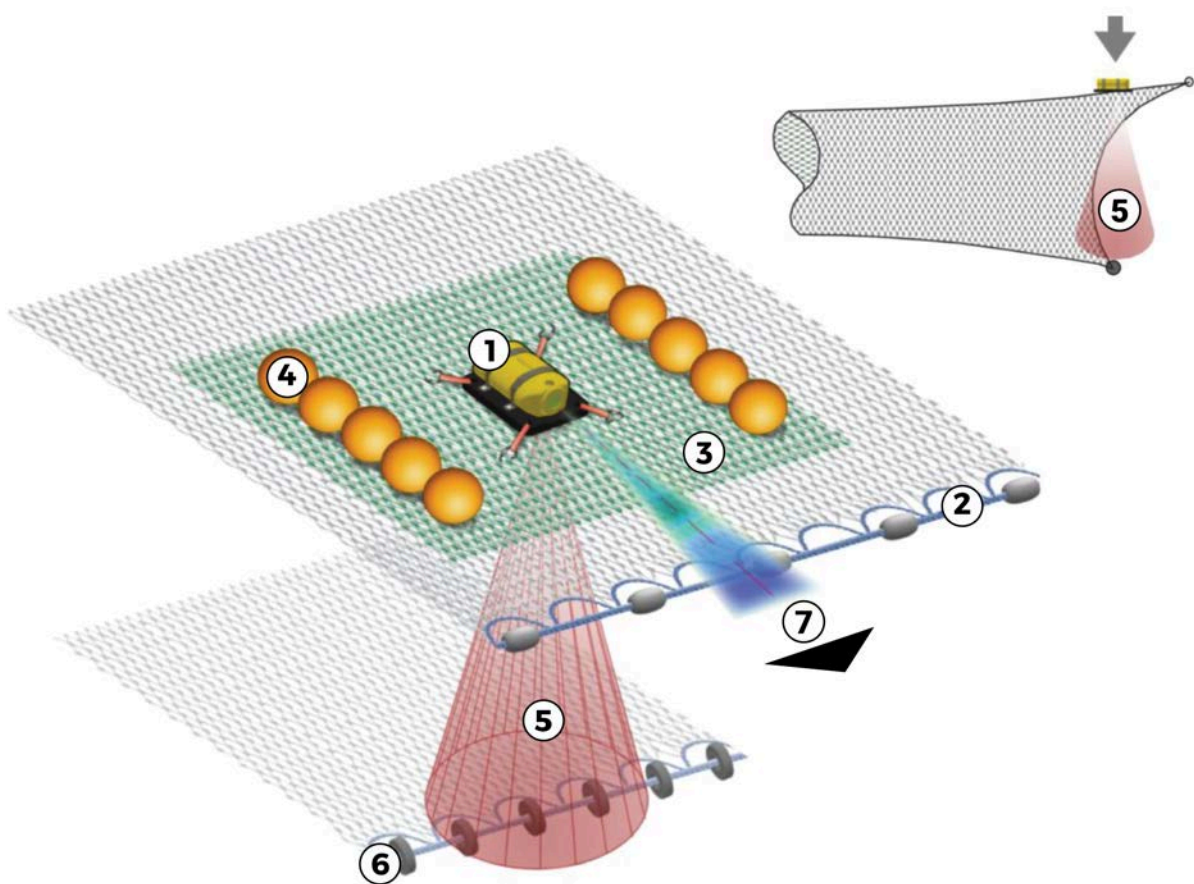

1. Place sensor (1) at the centre of the net's headrope (2), facing the vessel.
2. Install a double-mesh piece of netting (3) to stabilize the sensor.
3. Buoys (4) on either sides provide a level platform for the unit during trawling operations.
4. Buoys ensure that down-looking transducer beam (5) is vertical for footrope (6) detection.
5. The signal is oriented toward the vessel (7).

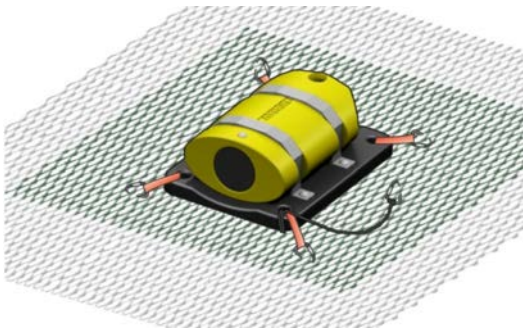

We recommend you to use a netting bag placed on a suitable location in the net. Use a safety line between one of the sensor's attachment lugs, as shown in the picture below. The safety line should be a steel wire with fitted small shackles at either end.

! **Important:** Sensors not properly secured may be lost during fishing operations.

Maintenance & Troubleshooting

Maintenance and Troubleshooting

Read this section for troubleshooting and maintenance information.

Charging the Sensor with the Dock

Connect a sensor to one of the 4 charging connectors of the Dock to display its level of charge.

- Make sure the Dock is connected to a power supply and turned on.



Warning: In case of water ingress in the product, do not charge it: battery may vent or rupture, causing product or physical damage.



Note: For Dock products with serial number before DOC2107XXX: Do not leave the sensors connected on a charger that is switched off. If the charger is not connected to the mains voltage, the sensor switches on and this will drain the battery.



Note: Avoid full discharges and charge the battery whenever possible, at any battery level. Lithium-ion batteries do not have a charge memory, so they do not need full discharge cycles.

1. Before charging the sensor: wash with fresh water and dry the sensor. This prevent corrosion of the charging pins.



Important: Check that the charging pins are not damaged. If they are, contact you local Marport dealer for replacement.

2. Connect the charger plug to one of the 4 charging ports.

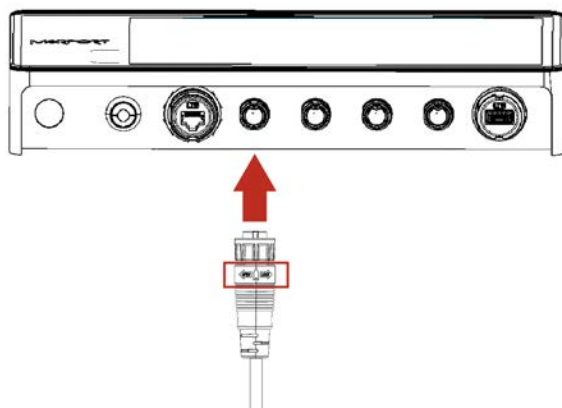

3. Connect the 3-pin charging connector to the sensor charging pins.

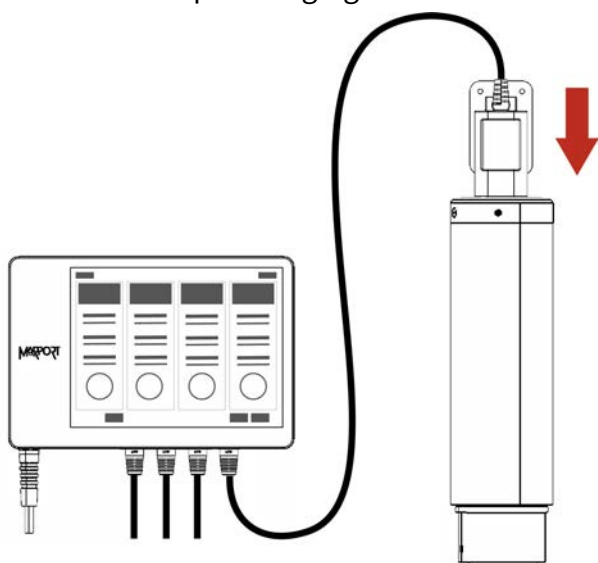

The Dock screen and Virtual Charger Room display the state of charge of the sensor.

Cleaning the Sensor

You need to regularly clean the sensor for proper performance.

Wash the sensor with fresh water and dry it before you charge or store it.

Regularly check that the sensor is clean. If not:

- Remove any marine life with a piece of wood or screwdriver.
- Wash away mud or debris with warm water.



Notice: Do not use highly abrasive materials or jet wash.



Notice: Special care should be taken with sensors and components sensitive to mechanical shock or contamination.

Maintenance Checklist

We recommend you to follow this maintenance schedule for better performance and to avoid any trouble with the equipment.

Before use	<ul style="list-style-type: none"> • Check that all attachment equipment are not worn or torn. Replace when appropriate. • Check that the sensor is clean. See Cleaning the Sensor (on page 52) for cleaning procedures. • Check the battery level 24 hours before use and recharge if necessary.
After use	Wash the sensor with fresh water.
Between uses	When the sensor is not in use, store in a dry area, without humidity, at a temperature between -10° and 70 °C (14 to 158 °F).
Not used for more than 3 months	<ul style="list-style-type: none"> • Do not leave the batteries at full charge or discharged for a long period of time or they will wear out. • Every 6 months, put the sensor in charge for less than an hour.
Every 2 years	The sensor must be returned to an approved Marport dealer for inspection and maintenance.

If the sensor has not been used for more than 3 months, we highly recommend to check the following points before using it:

- Make sure the sensors on the end cap are in good condition and clean.
- Connect the sensor to a charger and check the charging status.
- Switch on the sensor by shorting the center lug to the negative lug, then listen for a ping noise and check if you see the LED switched on.
- Test the sensor measures with Mosa2: depth, temperature, pitch, roll, and if applicable: spread distance, echogram, catch status, speed measures (using the EM log tester).
- If you have a test hydrophone, check the reception in the wheelhouse with Scala.

Troubleshooting

Learn how to solve common problems.

Mosa2 does not open due to error message

Mosa2 displays an error message saying it cannot be opened.

→ Your Mac security preferences do not allow you to open applications not downloaded from the App Store.

1. From the upper left corner of the screen, click **Apple menu > System Preferences > Security & Privacy**.
2. Click the lock icon and enter the password, if applicable.
3. At **Allow apps downloaded from**, select **Anywhere**, then close the dialog box.
4. **macOS Sierra or later:** **Anywhere** option is not displayed by default. To display **Anywhere**:
 - a. Click the magnifying glass from the top right corner of your screen and type `Terminal`.
 - b. Click **Terminal** from the results.
 - c. Enter in the terminal: `sudo spctl --master-disable`.
 - d. Press Enter.

Anywhere option is now displayed in **Security & Privacy** preferences.

Sensor does not connect correctly with Mosa2 when using the Configuration Cable



Remember: If the sensor does not connect correctly with Mosa2, always:

- Disconnect both USB connector and three-pin plug.
- Connect again the Configuration Cable.
- Make sure the three pins are fully inserted inside the sensor.

→ Mosa2 does not automatically open when connecting the Configuration Cable.

- Check that you see Marport Captain icon in the desktop taskbar. If you do not see it: close, then open Mosa2. The icon should appear in the taskbar.



Note: Marport Captain is a program running in the background. It allows Mosa2 automatic opening and displays shortcuts to Mosa2 and Scala applications installed on the computer. It should not be closed.

- If the problem persists, install Mosa2 again.

→ At the end of step 2 of the configuration wizard, the sensor does not respond. Mosa2 displays a red cross and the Configuration Cable LED is red.

- Check that no other instance of Mosa2 application is already running on the computer. If this is the case, close both applications, then open only one.
- Or else, connect the sensor to a charger and wait until it is fully charged.

→ The sensor has been disconnected from Mosa2.

- Check that the Configuration Cable is not connected to a USB hub. The Configuration Cable must be connected directly to the computer.
- If the computer goes to sleep mode, the sensor may be disconnected. Change the settings on your computer to increase the time before sleep mode.
- If the problem persists, connect the sensor to a charger and wait until it is fully charged. Then try again to connect.

→ Mosa2 displays a critical error message.

- Disconnect both USB connector and three-pin plug. Then, connect again the Configuration Cable. If the message is still displayed, it means there is an issue with the sensor's components. Contact Marport support.

The echogram has a lot of interference

→ There are interference from environmental noise or other equipment such as echosounders. You need to increase the level of the echogram filter in Scala2.

! **Important:** Increase the level of the echogram filter only if the echogram has a lot of interference. Be aware that this filter will remove small targets.

1. From Scala2, click **Menu**  > **Expert Mode** and enter the password `copernic`.
2. Right-click the IP address of the receiver at the bottom of the page, then click **Configure Receiver**.
3. Click the name of the sensor in the system tree view.
4. In **Sensor Options**, click **Configure** in front of **Echograms**.

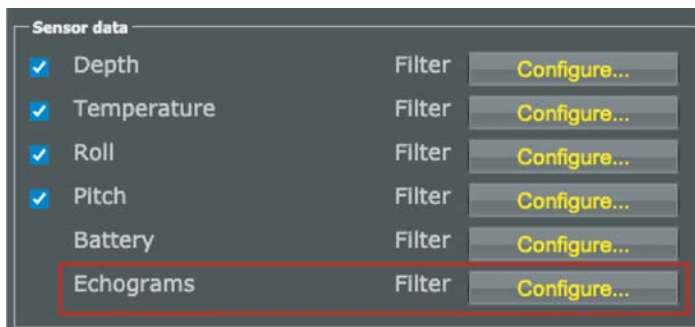

5. In **NBTE Echograms Filter**, select **Echosounder and Interference Reduction Medium** or **Echosounder and Interference Reduction High**.

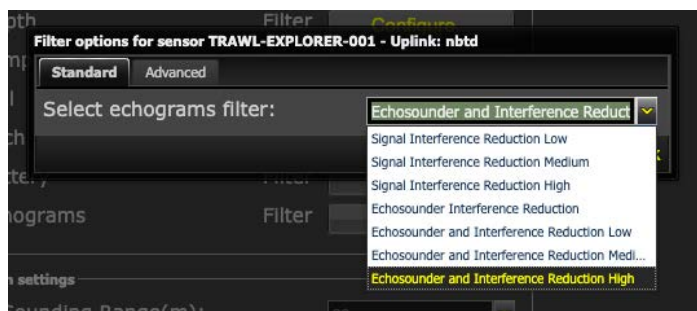

Here is an example of result when applying this filter:

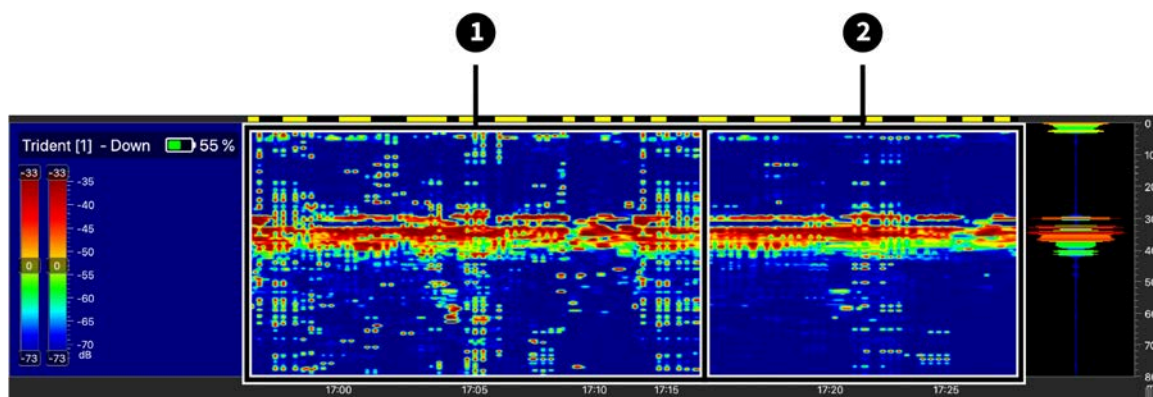

1. Noisy echogram with default filter (**Echosounder and Interference Reduction Low**)

2. With **Echosounder and Interference Reduction High** filter applied.

Support Contact

You can contact your local dealer if you need maintenance on your Marport products.

You can also ask us at the following contact details:

FRANCE

Marport France SAS

8, rue Maurice Le Léon

56100 Lorient, France

supportfrance@marport.com

NORWAY

Marport Norge A/S

Breivika Industrivei 69

6018 Ålesund, Norway

supportnorge@marport.com

SPAIN

ICELAND

Marport EHF

Tónahvarf 7

203 Kopavogur, Iceland

supporticeland@marport.com

SOUTH AFRICA

Marport South Africa

Cape Town, Western Cape

11 Paarden Eiland Road

Paarden Eiland, 7405

csanter@marport.com

UNITED KINGDOM

Marport Spain SRL

Camino Chouzo 1

36208 Vigo (Pontevedra), Spain

supportspain@marport.com

Marport UK Ltd

32 Wilson Street

Peterhead, AB42 1UD, United Kingdom

gyoungson@marport.com

USA

Marport Americas Inc.

12123 Harbour Reach Drive, Suite 100

Mukilteo, WA 98275, USA

supportusa@marport.com

Appendix

Frequency Plan

It is important to carefully plan the setup of your sensors before adding them to the system. You can create a table with a list of frequencies and complete it when you add sensors.

Frequencies and intervals

The diagrams below show the bandwidth of the different types of Marport sensors and intervals you must respect when adding other sensors.

Figure 1. PRP sensors (e.g. Catch sensor, Trawl Speed, Spread sensor...)

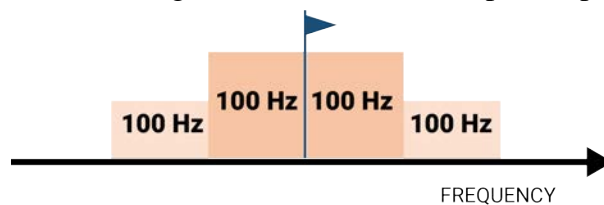

Example: If the frequency of the sensor is 40kHz, there should be no sensors between 39.9-40kHz and 40-40.1kHz.

Figure 2. Marport Pro sensors (e.g. Trident, Door Explorer, Trawl Navigator)

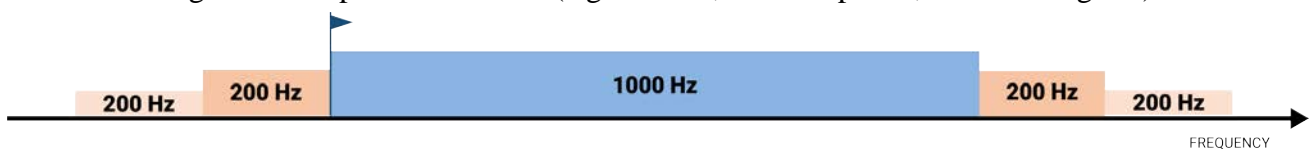

Example: If the frequency of the sensor is 40kHz, there should be no sensors between 39.8-40kHz and 40-50.2kHz.

Figure 3. NBTE sensors (e.g. Speed Explorer, Trawl Explorer, Catch Explorer, Door Sounder)

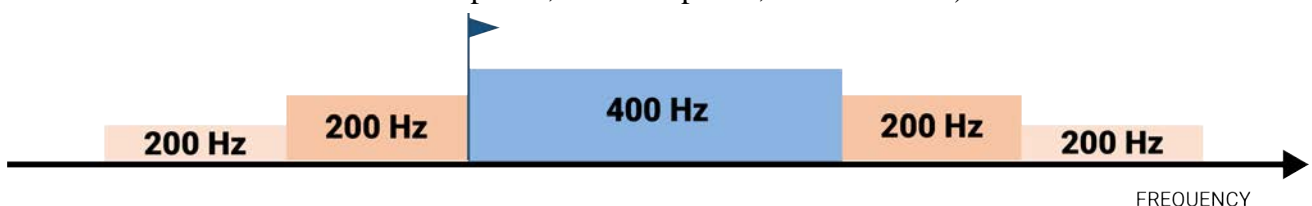

Example: If the frequency of the sensor is 40kHz, there should be no sensors between 39.8-40kHz and 40-40.6kHz.

Figure 4. HDTE narrow band mode

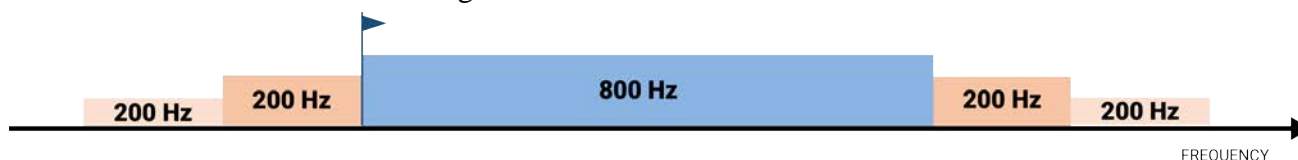

Example: If the frequency of the sensor is 40kHz, there should be no sensors between 39.8-40kHz and 40-41kHz.

Figure 5. HDTE wide band mode

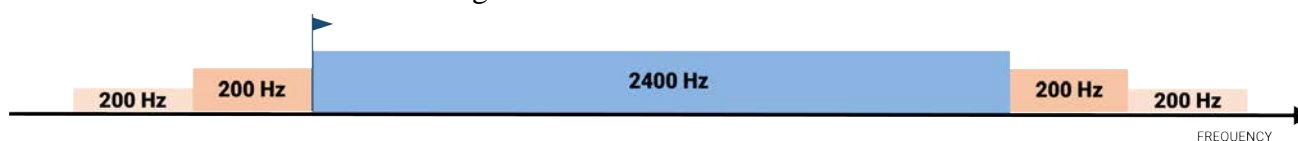

Example: If the frequency of the sensor is 40kHz, there should be no sensors between 39.8-40kHz and 40-42.6kHz.

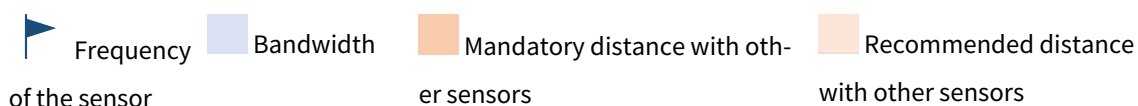

Examples of frequency allocations

- We recommend to allocate frequencies between 34 and 56 kHz for wideband hydrophones and between 41 kHz and 44 kHz for narrowband hydrophones.
- Echosounders are usually placed around 38 kHz, make sure to allow enough distance with them.

Example of a system with Spread, Catch, Trawl Speed sensors and Speed Explorer, Catch Explorer, HDTE and Door Sounder.

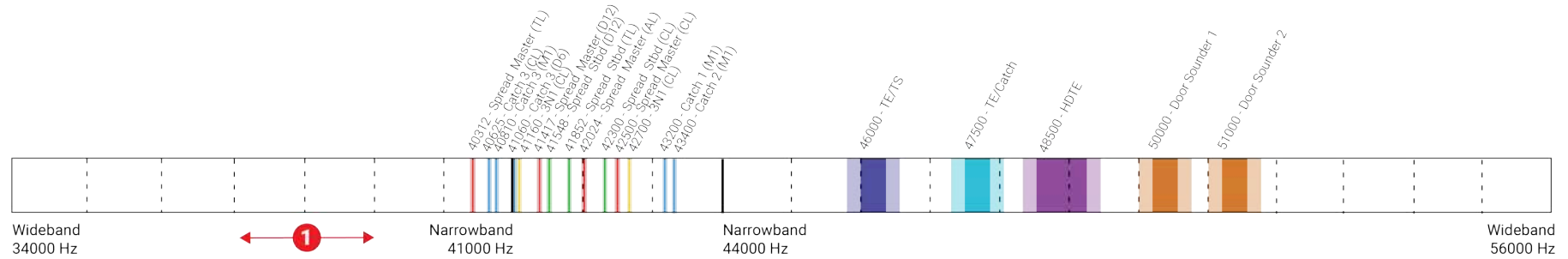

Example of a system with Spread sensors with positioning, Catch sensors, Trawl Explorer and Catch Explorer.

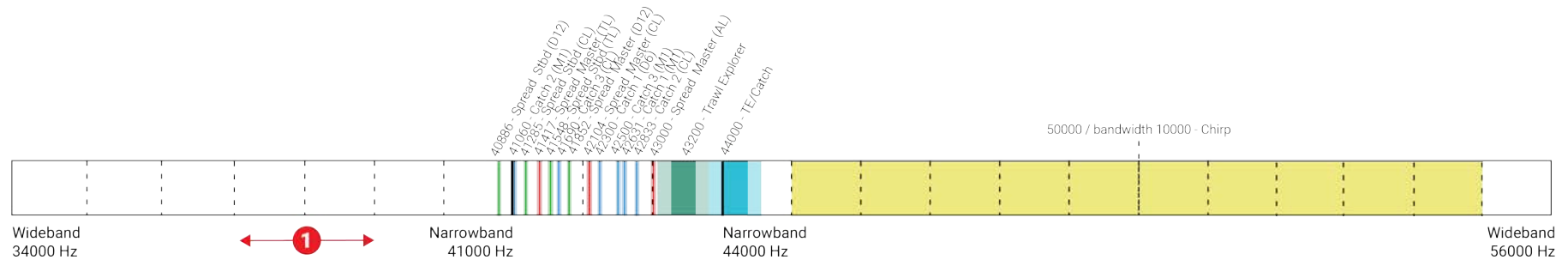

Example of a system for purse seining, with a Seine Explorer and depth Seine sensors.

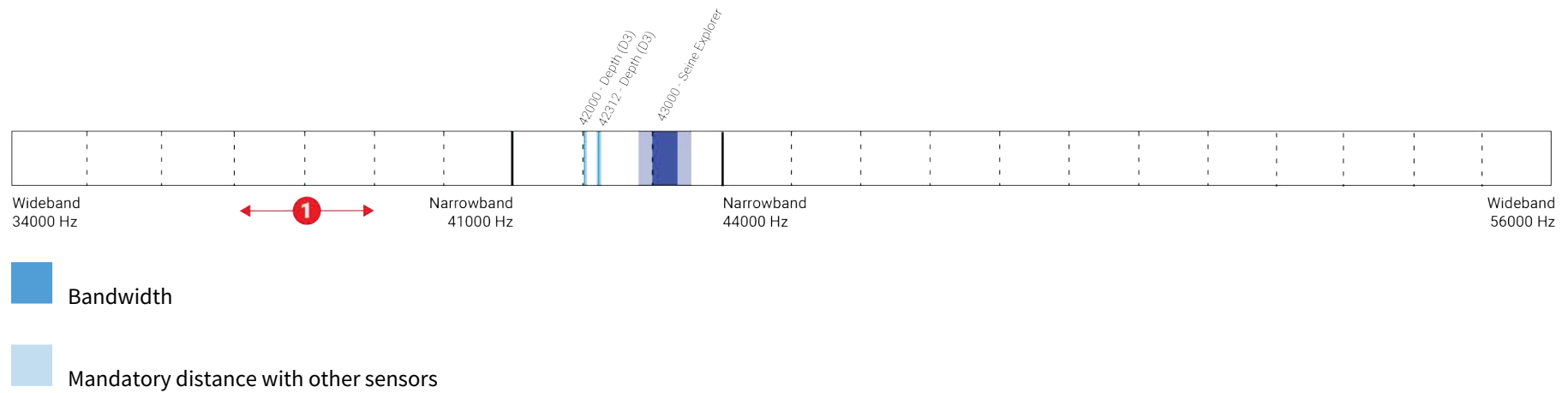

Index

A

Alarms

Concept **21**

Automatic range **6, 27**

B

Battery

Lifetime **20**

Boat code **59**

C

Channel code **59**

Charger

Connecting **51**

Cleaning **52**

Components **12**

Configuration Cable

Troubleshooting **55**

D

Diagnostic **21**

Display

Echogram **42**

Examples **6**

Dock **51**

E

Echo sounder **25**

End cap **12**

F

Frequency plan **59**

H

Housing

Description **12**

I

Installation

On headrope **48**

M

Maintenance

Schedule **53**

Measures **29**

Mosa2

Opening **17**

Mosa2 configuration

Change **33**

Delete **33**

Export **35**

Import **36**

Save **33**

O

Offsets

Depth **28**

Temperature **28**

P

PCBA **12**

R

Receiver

Adding to **39**

Compatibility **39**

Compatible firmware **39**

Sensor settings **40**

Replay

A2S files **45**

S

Scala2 **42**

SD card

Downloading data **31**

Recording **31**

Time synchronization **31**

Sensor location **48**

Sounding

Down **25**

Frequency **25**

Length **25**

Range **25**

TVG **25**

Up **25**

T

Trawl

Node **22**

U

Uplink

Frequency **24**

Power **24**

W

Warning **21**