



# ROTOTUNA HIGH SCHOOLS MONTHLY UPDATE

15 MARCH 2022

Check out what  
the we've been  
doing at your  
school!



## Surveying

Over the past month contractors have been identifying existing services and marked them out on site. Further to this, we have completed a 3D scan of the existing façade and all the staircase's around the Junior and Senior buildings. Behind the scene's we are modeling this information so that we can include this within the master building information model (BIM).

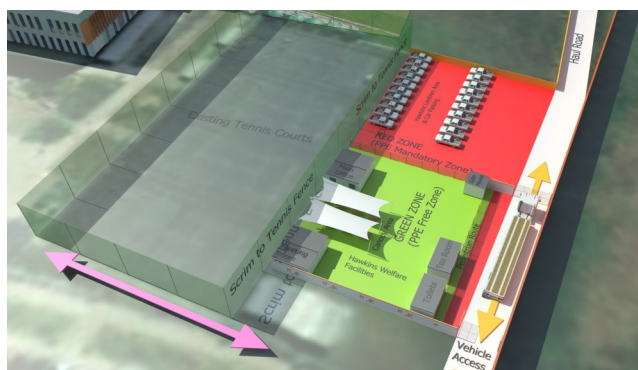

## Enabling works

Construction activities will begin on **Monday 28 March**. This beginning phase is all about setting up the site in preparation to commence the construction of the Whare building. Planning is key as we (Rototuna High School and Hawkins) what to make sure that we try to reduce any impact to school activities. So recently we have walked the site as to where the temporary fencing and hoarding will be installed. Hawkins will begin by installing timber hoarding behind the containers by the tennis courts. Then at the far north of the tennis courts, deer fencing will begin being erected to form the welfare facilities. Once the fencing us up the excavation team will commence with the haul road and laydown areas starting from **Monday 04 April**. You will start to notice deliveries for the site offices, security hut, tea room and toilet arriving on **Monday 11 April**.



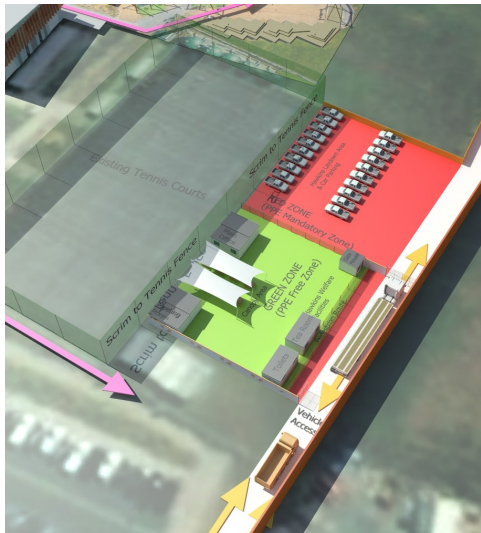

Welfare facilities set up

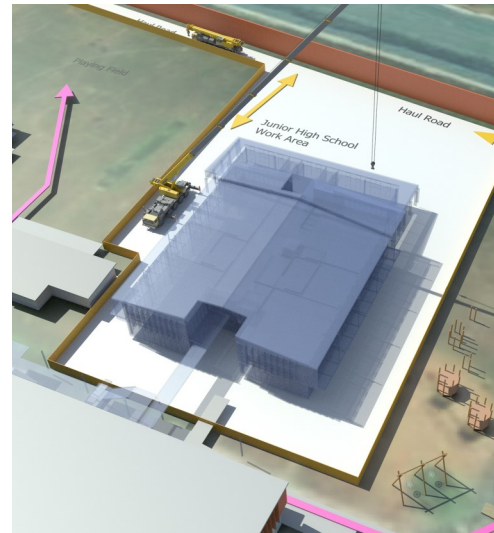

Junior building laydown area and building location

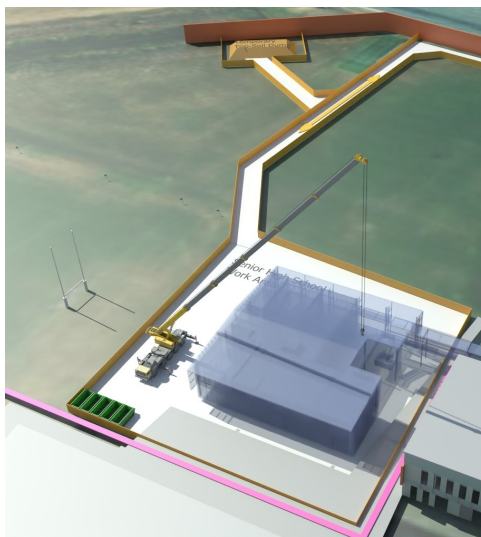

Senior building lay down area and building location

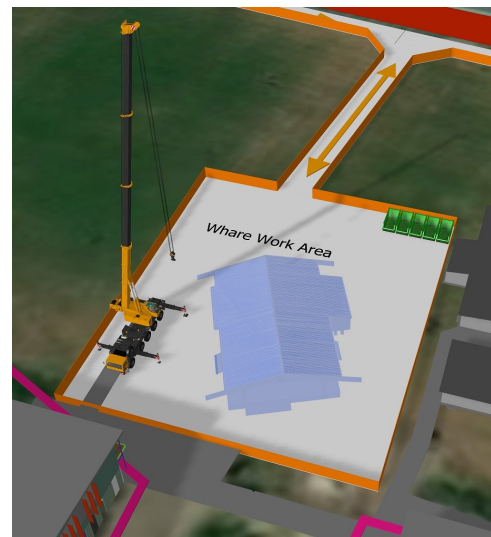

Whare building laydown area and building location

## What's happening next month?

- **Site Establishment** *duration 2 weeks*
  - **Fencing** *duration 2 weeks (one week for putting up and one week for placing scrim on fence)*
- **Playground relocation** *duration 3-4 weeks*
- **Preloading Junior and Senior buildings** *duration to install the preload is approx. 2-3 weeks. The preload will be in place for 20 weeks.*
- **Laydown areas for Whare, Junior and Senior buildings** *duration 7 days*

